

# CITY OF BERKELEY ALAMEDA COUNTY, CALIFORNIA

## PEDESTRIAN IMPROVEMENTS AT INTERSECTION OF WOOLSEY ST AND ETON AVE SPECIFICATION NO. 23-11614-C (RE-ISSUED)

### SHEET INDEX

No.	Sheet Title	Sheet
1.	TITLE SHEET	T-1
2.	GENERAL NOTES, SYMBOLS & LEGEND	G-1
3.	TYPICAL SECTIONS	TS-1
4.	DEMOLITION & UTILITY PROTECTION PLAN	EX-1
5.	LAYOUT PLAN	C-1
6.	GRADING PLAN	C-2
7.	DETAILED GRADING FOR CURB RAMPS & RAISED CROSSWALK	C-3
8.	CIVIL CONSTRUCTION DETAILS	C-4
9.	CIVIL CONSTRUCTION DETAILS	C-5
10.	SIGNAGE & STRIPING PLAN	SS-1

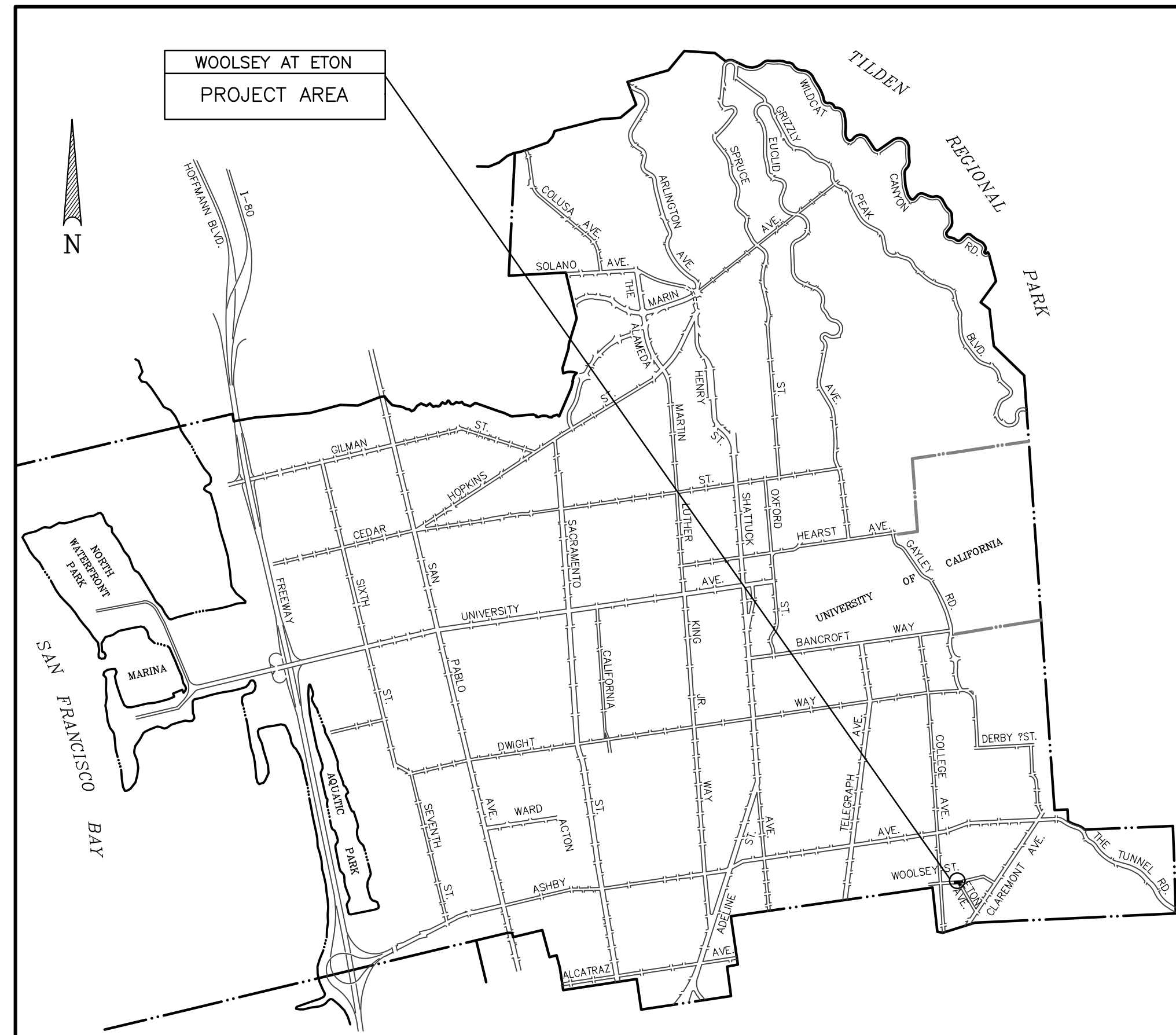

LOCATION MAP—CITY OF BERKELEY  
NOT TO SCALE

SURVEY CONTROL POINTS				
CONTROL DATA (U.S. SURVEY FOOT)				
—HORIZONTAL CONTROL IN GROUND VALUES USING AN ASSUMED ORIGIN				
—VERTICAL CONTROL IN CITY OF BERKELEY DATUM				
WOOLSEY STREET AT ETON AVENUE				
DESIGNATION	NORTHING	EASTING	ELEVATION	DESCRIPTION
<b>CITY MONUMENTS USED</b>				
B0033	2138088.911	6055357.613	215.56	IRON PIN CITY WELL MONUMENT
B2144	2138130.900	6055641.592	224.49	BRASS DISK CITY WELL MONUMENT
NOTE: MONUMENTS B2144 & B0033 ARE OUT OF PROJECT LIMITS SHOWN ON PLANS				
<b>CONTROL SET</b>				
CP 101	2138145.731	6056075.253	234.16	MAG NAIL IN PAVEMENT
CP 102	2138124.311	6055803.384	228.10	MAG NAIL IN PAVEMENT
NOTE: CONTROL POINTS CP 102 IS OUT OF PROJECT LIMITS SHOWN ON PLANS				
<b>CONTROL FOUND</b>				
NOTE: THE CONTROL TABLE VALUES CONTAINED HEREIN HAVE BEEN REVIEWED BY A CITY OF BERKELEY SURVEY CHIEF OF PARTY FOR CONFORMITY WITH RECORD INFORMATION ONLY. NO FIELD VERIFICATION OF THIS DATA HAS BEEN PERFORMED BY CITY OF BERKELEY SURVEY CREWS.				



**LCC** ENGINEERING & SURVEYING, INC.  
930 Estudillo Street  
Martinez, California 94553-1630  
(925) 228-4218 Fax (925) 228-4638  
www.lcc-inc.com

PROJECT MANAGER: \_\_\_\_\_ DATE \_\_\_\_\_  
SURVEY PARTY CHIEF \_\_\_\_\_  
WATERSHED REVIEW: \_\_\_\_\_ DATE 4/11/24

DEPICTION OF MONUMENTS: \_\_\_\_\_ DATE \_\_\_\_\_  
SUBMITTED: \_\_\_\_\_ DATE 04/04/24  
R.C.E. C67152  
EXP. 09/30/2024  
APPROVED: \_\_\_\_\_ DATE 4/11/24  
R.C.E. C62524  
EXP. 9/30/25

DESIGN: \_\_\_\_\_  
DRAWN: \_\_\_\_\_  
CHECK: \_\_\_\_\_  
AS BUILT: \_\_\_\_\_

HORIZ: \_\_\_\_\_  
VERT: \_\_\_\_\_  
BOOK: \_\_\_\_\_  
DATE: 03/22/24

CITY OF BERKELEY  
DEPARTMENT OF PUBLIC WORKS

PEDESTRIAN IMPROVEMENTS AT INTERSECTION  
OF WOOLSEY STREET AT ETON AVE  
TITLE SHEET

PLAN 8276  
FILE 503-635  
T-1  
SHEET 1 OF 10

REVISION	MARK	DATE	DESCRIPTION	APPROVAL



GENERAL NOTES

- ANY DAMAGE TO THE EXISTING FACILITIES INCLUDING TREES, LANDSCAPING, IRRIGATION, FENCES, WALLS, SIDEWALK, MAILBOXES, UTILITIES, AND OTHER PAVEMENT SURFACES SHALL BE REPAIRED AT CONTRACTOR'S EXPENSE. CONTRACTOR SHALL RESTORE ANY AND ALL PAVEMENT AND OTHER FACILITIES OUTSIDE LIMITS OF WORK AFFECTED BY THE CONSTRUCTION OPERATIONS AT NO ADDITIONAL COST. IT IS THE CONTRACTOR'S RESPONSIBILITY TO VIDEOTAPE OR DOCUMENT EXISTING CONDITIONS PRIOR TO START OF WORK TO SUBSTANTIATE ANY PREVIOUS DAMAGE, ETC.; COPIES OF WHICH SHALL BE PROVIDED TO THE ENGINEER.
- ALL CITY OF BERKELEY MONUMENTS LOCATED WITHIN THE PROJECT AREA MUST BE REFERENCED, PRIOR TO WORK COMMENCING, BY A LICENSED LAND SURVEYOR AS REQUIRED BY SECTION 8771 OF THE BUSINESS AND PROFESSIONS CODE. CORNER RECORDS OF THIS WORK MUST BE SUBMITTED FOR FILING TO BOTH THE COUNTY SURVEYOR OF ALAMEDA COUNTY, AND THE CITY OF BERKELEY, PUBLIC WORKS DEPARTMENT, ENGINEERING DIVISION, SURVEY SECTION.
- MOBILIZATION SHALL BE AS PROVIDED IN THE PROJECT SPECIFICATIONS AND INCLUDES LAND SURVEYING TASKS DURING CONSTRUCTION, WATER POLLUTION CONTROL PLAN AND IMPLEMENTATION, TRAFFIC CONTROL AND STAGING PLAN AND IMPLEMENTATION.
- ALL LAND SURVEYING TASKS SHALL BE DONE BY A LICENSED LAND SURVEYOR PROVIDED BY THE CONTRACTOR.
- CONTRACTOR SHALL BE RESPONSIBLE FOR CONSTRUCTION SURVEYS AND LAYOUT INCLUDING SETTING CONTROL POINTS/LINES AND CONSTRUCTION STAKING AS REQUIRED TO BUILD THE IMPROVEMENTS SHOWN ON THE CONTRACT PLANS.
- CONTRACTOR SHALL PREPARE WATER POLLUTION CONTROL PLAN FOR REVIEW AND APPROVAL BY THE CITY'S REPRESENTATIVE PRIOR TO THE START OF CONSTRUCTION. CONTRACTOR SHALL INSTALL TEMPORARY WATER POLLUTION CONTROL MEASURES PRIOR TO THE START OF CONSTRUCTION AS APPROVED BY THE CITY'S REPRESENTATIVE.
- ALL STRIPING AND MARKINGS SHALL BE THERMOPLASTIC, UNLESS INDICATED OTHERWISE ON PLANS.
- ALL BLUE RETROREFLECTIVE FIRE HYDRANT MARKERS SHALL BE SET 6" OFF THE STREET CENTERLINE OR AS SHOWN IN THE CA MUTCD.
- CONTRACTOR SHALL SUBMIT CONSTRUCTION STAGING PLAN AND TRAFFIC CONTROL PLAN FOR ALL STAGES OF CONSTRUCTION FOR APPROVAL BY THE CITY PRIOR TO THE START OF CONSTRUCTION.
- TRAFFIC CONTROL DURING CONSTRUCTION SHALL BE THE CONTRACTOR'S RESPONSIBILITY AND IN ACCORDANCE WITH THE CONTRACT DOCUMENTS. THE CONTRACTOR SHALL PROVIDE ALL LIGHTS, SIGNS, BARRICADES, FLAGMEN, AND OTHER DEVICES TO PROVIDE FOR SAFE PASSAGE OF PUBLIC VEHICULAR AND PEDESTRIAN TRAFFIC IN ACCORDANCE WITH CA MUTCD.
- THE CONTRACTOR IS RESPONSIBLE FOR CREATING AND PROVIDING A TRAFFIC CONTROL PLAN INCLUDING ACCESS AND DETOURS FOR PEDESTRIANS, BICYCLISTS, AND VEHICLES AT ALL TIMES DURING CONSTRUCTION. THE CONTRACTOR SHALL SUBMIT TO THE CITY FOR APPROVAL PRIOR TO STARTING ANY WORK. THE CONTRACTOR SHALL INCLUDE ALL RELATED COSTS FOR PREPARING, SUBMITTING, REVISING, AND RESUBMITTING THIS PLAN TO THE CITY IN HIS/HER BID.
- CONTRACTOR SHALL MAINTAIN 11' WIDE VEHICLE LANES AT ALL TIMES.
- THE PEDESTRIAN ACCESS AND DETOUR SHALL BE 4'-FOOT WIDE MINIMUM, ADA COMPLIANT/ALL WEATHER PATH OF TRAVEL AT ALL TIMES DURING CONSTRUCTION. THE BICYCLIST ACCESS AND DETOUR SHALL BE 5'-FOOT MINIMUM WIDE ALL WEATHER PATH OF TRAVEL AT ALL TIMES DURING CONSTRUCTION AND SEPARATE FROM PEDESTRIANS.
- THE CONTRACTOR SHALL CONTACT AC TRANSIT AT LEAST THREE WEEKS IN ADVANCE OF PERFORMING WORK SHOULD ANY STREET OR LANE CLOSURES REQUIRE RE-ROUTING OF PUBLIC TRANSIT. CONTRACTOR SHALL COORDINATE WITH AC TRANSIT FOR TEMPORARY BUS STOP LOCATIONS DURING CONSTRUCTION PERIOD, IF REQUIRED.
- TYPICAL DETAILS REFERRED TO ON THESE DRAWINGS ARE FROM THE LATEST VERSIONS OF THE CALIFORNIA DEPARTMENT OF TRANSPORTATION (CALTRANS) STANDARD PLANS, CA MUTCD, AND CITY STANDARD PLANS.
- CONTRACTOR SHALL PROTECT FULL DIAMETER OF CURB DRAIN OUTLETS DURING PAVEMENT AND CONCRETE WORK. EXISTING CURB DRAINS TO REMAIN EXPOSED DURING AND AFTER WORK IS COMPLETE. HANDWORK MAY BE REQUIRED TO PROTECT CURB DRAIN.
- CONTACTING USA DOES NOT RELIEVE THE CONTRACTOR FOR HIS/HER RESPONSIBILITY TO DETERMINE LOCATION AND DEPTH OF BURIED UTILITIES OR REPAIR BURIED UTILITIES DAMAGED BY HIS/HER OPERATION. THE CONTRACTOR SHALL LOCATE AND PRESERVE ALL FACILITIES INCLUDING SEWER, WATER, GAS, IRRIGATION, POWER, STREET LIGHTS, TELEPHONE AND OTHERS WHICH MAY BE IN THE AREA OF CONSTRUCTION.
- ALL EXCAVATED SOIL & REMOVED MATERIALS SHALL BE LOADED DIRECTLY INTO TRUCKS & DISPOSED OF AT AN APPROVED DUMP SITE.
- CONTRACTOR WILL NOT BE ALLOWED TO STAGE EQUIPMENT OR MATERIALS ON CITY STREETS EXCEPT AS APPROVED BY THE CITY PRIOR TO THE START OF CONSTRUCTION. SHOULD THE PERMIT HOLDER OR HIS/HER CONTRACTORS WISH TO STOCKPILE MATERIALS NEAR THE WORK SITE, THEY SHALL MAKE ARRANGEMENTS IN ADVANCE FOR STORAGE. ALL STORAGE SITES SHALL BE SECURE, INACCESSIBLE TO THE GENERAL PUBLIC AND KEPT FREE OF CONSTRUCTION SOIL, DEBRIS AND TRASH AT ALL TIMES. EQUIPMENT SHALL BE SECURED AND LOCKED WITH PROTECTIVE COVERS IN PLACE. ADEQUATE BARRICADES WITH OPERABLE FLASHERS SHALL BE INSTALLED AROUND THE EQUIPMENT AND REMAIN IN WORKING ORDER AT ALL TIMES. STORAGE SITES SHALL BE SUBJECT TO THE REVIEW AND APPROVAL OF THE CITY OF BERKELEY.

ABBREVIATIONS

AB	AGGREGATE BASE
AC	ASPHALT CONCRETE
ADA	AMERICANS WITH DISABILITIES ACT
ADJ	ADJUST
BBL UP DRN	BUBBLE UP DRAIN
BC	BEGIN CURVE
BLDG	BUILDING
BFP	BACK FLOW PREVENTER
B/W	BACK OF WALK
C	CONCRETE
C/L	CENTER LINE
CI	CAST IRON
CLF	CHAIN LINK FENCE
CMP	CITY OF BERKELEY
CMPA	CORRUGATED METAL PIPE
COB	CORRUGATED METAL PIPE ARCH
COMP	COMPACTION
CONC	CONCRETE
CONSTR	CONSTRUCT
CP	CONTROL POINT
CR	CURB RAMP
D/W	DRIVEWAY
DEMO	DEMOLISH
DI	DRAIN INLET
DWY	DRIVEWAY
EA	EACH
EC	END CURVE
EL	ELEVATION
ELEC	ELECTRICAL
ELEV	ELEVATION
EP	EDGE OF PAVEMENT
(E)	EXISTING
EX	EXISTING
EXIST	EXISTING
FD	EXISTING
FDR	EXISTING
FG	FOUND
FH	FULL-DEPTH RECLAMATION
F/L	FINISH GRADE
FL	FIRE HYDRANT
G	FLOW LINE
GRT	FLOW LINE
GUT	GAS
GV	GRATE
(H)	FLOWLINE GUTTER
HMA	GAS VALVE
HORIZ	HORIZONTAL
I.C.	HOT MIX ASPHALT
INV	HORIZONTAL
IP	INTER COMM.
IRR	INVERT
JP	IRON PIPE
LF	IRRIGATION
LS	JOINT POLE
LT	LINEAR FEET
LT	LANDSCAPE AREA
MAG	LEFT
NL	LIGHT
MAX	MAGNETIC NAIL
MET	MAXIMUM
MH	MAXIMUM
MIN	METAL
MON	MAINTENANCE HOLE
MRK	MINIMUM
OH	SURVEY MONUMENT
O/H	MARKER
P	OVERHEAD
PCC	OVERHEAD
PED	PAVEMENT
P-L	PORTLAND CEMENT CONCRETE
PRC	PEDESTAL
PVC	PIPE LINE
R	POINT OF REVERSE CURVE
RCB	POLYVINYLCHLORIDE PIPE
RCP	RADIUS
REL.	REINFORCED CONCRETE BOX
RET	REINFORCED CONCRETE PIPE
RHMA	RELATIVE
RT	RETAINING
RW	RUBBERIZED HOT MIX ASPHALT
S	RETAINING
SD	REDWOOD TREE
SDDI	SLOPE OR SWALE
SDMH	STORM DRAIN
SO	STORM DRAIN DRAIN INTAKE
SS	STORM DRAIN MAINTENANCE HOLE
SSMH	SIDE OPENING
SSCO	SANITARY SEWER
STA	SANITARY SEWER MAINTENANCE HOLE
STD	SANITARY SEWER CLEAN OUT
STDS	STATION
S/W	STANDARD
SYC	STANDARDS
T/C	SIDEWALK
TC	SYCAMORE
TCDI	TOP OF CURB
TD	TOP OF CURB
TEL	TOP OF CURB AT DRAIN INLET
TW	TOP OF DIKE
TYP	TELEPHONE
U.G.	TOP OF WALL
UNK	TYPICAL
(V)	UNDERGROUND
VCP	UNKNOWN
VERT	VERTICAL
V.G.	VITRIFIED CLAY PIPE
VEH.	VERTICAL
W	VALLEY GUTTER
W/	VEHICLE
WD	WATER
WI	WITH
WM	WOOD
WV	WROUGHT IRON FENCE
w/	WATER METER
	WATER VALVE
	WITH
	CROSS DRAIN

CONCRETE WORK NOTES

X-DRAIN

GENERAL NOTES FOR CONCRETE FLAT WORK

- CURB RAMPS SHALL CONFORM TO THE LATEST EDITION AND REVISED STANDARD PLAN (RSP) OF THE (CALIFORNIA DEPARTMENT OF TRANSPORTATION) STANDARD SPECIFICATIONS AND STANDARD PLAN AB8A AND AB8B.
- PORTLAND CEMENT CONCRETE FOR SIDEWALK, CURB, DRIVEWAY, GUTTER AND VALLEY GUTTER SHALL BE MINOR CONCRETE CONFORMING TO THE REQUIREMENTS OF SECTION 90-2 "MINOR CONCRETE" OF THE (CALIFORNIA DEPARTMENT OF TRANSPORTATION) STANDARD SPECIFICATIONS. NO BAGGED MIX IS PERMITTED.
- BUS PAD CONCRETE SHALL BE DESIGNED WITH A MINIMUM COMPRESSIVE STRENGTH OF 3,500 PSI AND SHALL BE SAMPLED (3 CYLINDERS REQ'D) AND TESTED.
- EXISTING SUBGRADE SURFACE SHALL BE RE-GRADED (IF NECESSARY) AND RE-COMPACTED (MIN 95% RELATIVE COMPACTION) TO CONFORM TO THE GRADES SHOWN ON THE PLANS.
- NEW CONCRETE WORK SHALL MATCH EXISTING IN FINISH, SCORE PATTERN, AND COLOR, OR AS SHOWN ON THE PLANS, OR AS DIRECTED BY THE ENGINEER.
  - ROSE COLORED CONCRETE SHALL CONTAIN 6 POUNDS OF DAVIS #160 (ROSE) PER CUBIC YARD.
  - ALL OTHER CONCRETE SHALL CONTAIN 1.5 POUND OF LAMPBLACK PER CUBIC YARD.
- NO ADMIXTURES SHALL BE USED WITHOUT APPROVAL OF THE ENGINEER.
- CURBS, SIDEWALKS, DRIVEWAYS, AND CURB RAMPS SHALL HAVE FORMS REMOVED AND BE BACKFILLED WITHIN 3 DAYS AFTER PLACING CONCRETE. CONCRETE SHALL BE ALLOWED TO CURE FOR AT LEAST 48 HOURS PRIOR TO BACKFILLING.
- MAXIMUM SLUMP OF FRESH CONCRETE PERMITTED IN THESE ITEMS SHALL BE 4 INCHES. SLUMP SHALL BE DETERMINED BY EITHER ASTM C-143 OR CALIFORNIA TEST METHOD NO. 520 AT THE ENGINEER'S DISCRETION. CONCRETE SHALL BE TRANSPORTED IN TRUCK MIXERS OR AGITATORS AND DISCHARGED WITHIN 70 MINUTES OF LEAVING THE PLANT.
- WEAKENED PLANE JOINTS AT LEAST 1-1/2 INCHES DEEP AND 1/8 INCHES WIDE SHALL BE PLACED AT 10 FEET MAXIMUM SPACING.
- EXPANSION JOINT FILLER FOR CONCRETE (BITUMINOUS TYPE) MUST BE IN COMPLIANCE WITH ASTM D 994.
- ALL NEW CURB, SIDEWALK, VALLEY GUTTER AND DRIVEWAYS CONSTRUCTED ADJACENT TO EXISTING CONCRETE CURB OR SIDEWALK SHALL BE DOWELED TO THE EXISTING CONCRETE. THE DOWELS SHALL BE #4 REBAR, 18 INCHES LONG AT 18 INCHES MAXIMUM SPACING. DOWELS SHALL BE EMBEDDED A MINIMUM OF 8-INCHES IN A 5/8 INCH DRILLED HOLE (EXIST. CONC.).
- SIDEWALK SHALL BE CONSTRUCTED WITH EXPANSION JOINTS AT EACH BEGINNING OF CURVE (BC) AND END OF CURVE (EC).
- CURB AND GUTTER, SIDEWALKS AND DRIVEWAYS SHALL BE GIVEN A MEDIAN BROOM FINISH. THE SURFACE SHALL FIRST BE GIVEN A FLOATED FINISH AND FINAL TROWELING SHALL BE DONE WITH A STEEL TROWEL. THE FINISHED SURFACE SHALL BE FREE OF ALL TROWEL MARKS AND SHALL BE UNIFORM IN TEXTURE AND APPEARANCE, BROOM TEXTURE SHALL BE IN THE LONGITUDINAL DIRECTION.
- CLASS 2 AGGREGATE BASE (CL 2 AB) SHALL CONFORM TO THE CALTRANS STANDARD SPECIFICATIONS (LATEST EDITION) AND SHALL BE COMPACTED TO A MINIMUM DENSITY OF 95% RELATIVE COMPACTION.
- EXISTING ASPHALT CONCRETE SHALL BE SAWCUT, REMOVED AND RECONSTRUCTED FOR A MINIMUM OF 2-FEET WITHIN EDGES OF CONCRETE WORK. HOT MIX ASPHALT SHALL BE A MINIMUM THICKNESS OF 8" AND CL 2 AB SHALL MATCH EXISTING THICKNESS, AS APPROVED BY THE CITY ENGINEER. SEE PLAN 8148 "CURB AND GUTTER RETROFIT" FOR ADDITIONAL REQUIREMENTS.

CITY OF BERKELEY DEPARTMENT OF PUBLIC WORKS		STANDARD DETAIL CONCRETE WORK NOTES	
SUBMITTED:	DATE: 2/27/17	DESIGN: HEI	DATE: 01/26/17
APPROVED:	R.C.E. 64582	DRAWN: HEI	SCALE: N.T.S.
MANAGER OF ENGINEERING	R.C.E. 66014	CHECK: MS	BOOK: _____
		FILE: 20B-156	SHEET: 1 OF 1

EXISTING CONDITIONS LEGEND

— E —	Electric Conduit
— - - —	Property Line
— G —	Gas Line
— SD —	Storm Drain Line
— SS —	Sanitary Sewer Line
— TEL —	Telephone Conduit
— TV —	Cable Television Conduit
— W —	Water Line
— IRR —	Irrigation Conduit
— / / —	Edge of Pavement
— / / / —	Wall (Size and Type)
— / / / / —	Building Wall
— / / / / / —	Edge of Vegetation
— ( ) —	Shrub
— ( ) —	Trees (Size and Type)
— ( ) —	Maintenance hole
— ( ) —	Spot Elevation
— ( ) —	Survey Control Point
— ( ) —	Sign
— ( ) —	COB Survey Monument

TREE PROTECTION NOTES

- NO STREET TREE ROOTS ARE TO BE CUT WITHOUT APPROVAL OF CITY'S URBAN FORESTRY UNIT BY CALLING (510) 981-6660.

DEMOLITION NOTES

- CONTRACTOR SHALL VERIFY ALL CONDITIONS IN THE FIELD BEFORE COMMENCING ANY WORK AND REPORT ANY DISCREPANCIES BETWEEN PLANS AND ACTUAL CONDITIONS TO THE CITY OF BERKELEY (CITY). CONTRACTOR'S ATTENTION IS DIRECTED TO THE CLEARING AND GRUBBING PROVISIONS IN THE PROJECT SPECIAL PROVISIONS.

CIVIL CONSTRUCTION NOTES

- RIMS OF EXISTING UTILITY BOXES AND OTHER RELATED APPURTENANCES THAT ARE TO REMAIN SHALL BE PROTECTED DURING CONSTRUCTION AND SHALL BE ADJUSTED TO FINISH GRADES TO MAINTAIN ACCESSIBLE PATH.
- ALL MAINTENANCE HOLES, VALVES AND MONUMENT FRAMES SHALL BE SET TO FINISH GRADE AFTER/DURING PAVING AND TO MAINTAIN ACCESSIBLE PATH.
- THE CONTRACTOR IS RESPONSIBLE FOR MATCHING EXISTING STREETS, SURROUNDING LANDSCAPE & OTHER IMPROVEMENTS WITH A SMOOTH TRANSITION IN GRADE AVOIDING ABRUPT OR APPARENT CHANGES IN GRADE OR CROSS SLOPE, LOW SPOTS OR HAZARDOUS CONDITIONS.
- SUBGRADE SHALL BE THOROUGHLY WETTED IMMEDIATELY PRIOR TO PLACING CONCRETE. NO CONCRETE SHALL BE PLACED UNTIL THE CITY HAS INSPECTED AND APPROVED FORMS AND SUBGRADE.
- CONTRACTOR SHALL PROVIDE ADA COMPLIANT PATH OF TRAVEL ACROSS NEW CROSSWALKS AS SHOWN ON THE PLANS. CONTRACTOR SHALL CONFIRM A MINIMUM OF 4' WIDE PATH WITH 1.5% MAX CROSS SLOPE AND 5% MAX LONGITUDINAL SLOPE WILL BE PROVIDED. CONTRACTOR SHALL NOTIFY THE ENGINEER IMMEDIATELY IF THIS IS NOT THE CASE.
- APPROXIMATE SAWCUT AND EXCAVATION LIMITS ARE SHOWN ON THESE PLANS. FINAL SAWCUT AND EXCAVATION LIMITS SHALL BE AS DIRECTED BY THE CITY. CONTRACTOR SHALL VERIFY SIDEWALK RECONSTRUCTION LIMITS WITH ENGINEER PRIOR TO START OF CONSTRUCTION.
- NEW CURB FLOWLINE GRADES SHALL BE A MINIMUM OF 0.5% TO PROVIDE FOR POSITIVE DRAINAGE (EXCEPT WHERE SHOWN OTHERWISE ON THE PLANS OR APPROVED BY ENGINEER). CONTRACTOR SHALL IMMEDIATELY NOTIFY THE CITY IF THE MINIMUM IS NOT BEING MET PRIOR TO THE START OF THE IMPROVEMENTS.
- ACCESS TO PRIVATE PROPERTIES DURING CONSTRUCTION HOURS SHALL BE MAINTAINED TO THE EXTENT FEASIBLE. SHOULD ACCESS BE AFFECTED DURING CONSTRUCTION HOURS, CONTRACTOR SHALL NOTIFY THE CITY AND PROPERTY OWNERS PRIOR TO THE START OF CONSTRUCTION. ACCESS TO PRIVATE PROPERTY IF AFFECTED DURING CONSTRUCTION HOURS, SHALL BE RE-ESTABLISHED AT THE END OF EACH WORK DAY.

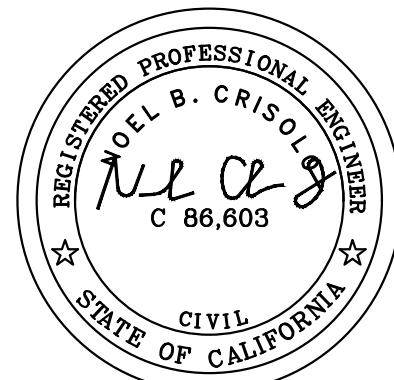

**L&C** ENGINEERING & SURVEYING, INC.  
 930 Estudillo Street  
 Martinez, California 94553-1630  
 (925) 229-4218 Fax (925) 229-4638  
 www.lc-enc.com

PROJECT MANAGER:	DATE:	DEPICTION OF MONUMENTS:	DATE:
SURVEY PARTY CHIEF:	DATE:	WATERSHED REVIEW:	DATE:

SUBMITTED:	DATE:	DESIGN:	MMV
SUPERVISING CIVIL ENGINEER	EXP.:	DRAWN:	NBC
APPROVED:	DATE:	CHECK:	CMP
CITY ENGINEER	EXP.:	AS BUILT:	DATE: 03/22/24

PLAN:	8276
FILE:	503-635
G-1	
SHEET:	2 OF 10

CITY OF BERKELEY  
DEPARTMENT OF PUBLIC WORKS

PEDESTRIAN IMPROVEMENTS AT INTERSECTION  
OF WOOLSEY STREET AT ETON AVE  
PROJECT NOTES, LEGEND  
AND ABBREVIATIONS

APPROVAL
REVISION
MARK
DATE
DESCRIPTION



UTILITY ADJUSTMENT TABLE

#	DESCRIPTION	EXISTING ELEV.	PROPOSED ELEV.	ADJUSTMENT
①	AT&T MH	233.52±	232.52±	No Change
②	COB Sewer MH	232.82±	232.82±	No Change
③	COB Sewer MH	233.64±	233.80±	+ 0.16±
④	COB Storm Drain MH	234.69±	234.67±	- 0.02±
⑤	COB Sewer MH	234.60±	234.95±	+ 0.35±
⑥	EBMUD WV	234.36±	234.90±	+ 0.64±
⑦	EBMUD WV	234.91±	234.91±	No Change
⑧	EBMUD WV	235.45±	235.45±	No Change
⑨	EBMUD WV	234.28±	234.28±	No Change

NOTES:

- CONTRACTOR SHALL BE RESPONSIBLE FOR ANY TEMPORARY ADJUSTMENTS REQUIRED DURING CONSTRUCTION (LOWER FACILITIES FOR PAVEMENT REMOVAL AND RAISE TO FINAL GRADE SHOWN)
- CONTRACTOR SHALL BE RESPONSIBLE FOR COORDINATING WITH UTILITY AGENCIES FOR ADJUSTMENTS OF STRUCTURES NOT OWNED AND/OR MAINTAINED BY THE COB.
- SEE SIGNAGE & STRIPING PLAN FOR DEMOLITION OF EX SIGNS.
- ALL EXISTING UTILITIES SHALL BE PROTECTED UNLESS OTHERWISE NOTED ON PLANS.
- CONTRACTOR SHALL VERIFY IF CONCRETE GUTTER IS PRESENT UNDER EXISTING AC. CONTRACTOR SHALL TAKE CARE WHEN REMOVING PAVEMENT TO NOT DAMAGE EXISTING GUTTERS.

DEMOLITION LEGEND

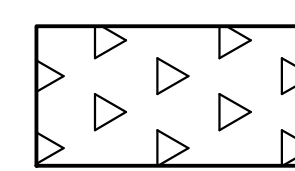
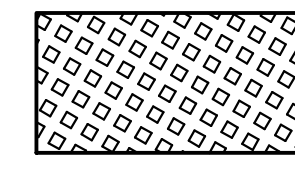
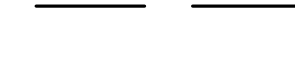
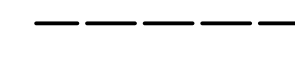
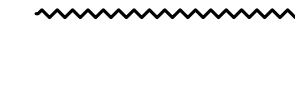
-  REMOVE EX. AC PAVEMENT (AND UNDERLYING BASE AS NEEDED TO NEW SUBGRADE ELEVATION).
-  REMOVE EX. CONCRETE PAVEMENT (AND UNDERLYING BASE AS NEEDED TO NEW SUBGRADE ELEVATION).
-  LIMITS OF NEW CONCRETE MEDIANS
-  SAWCUT, MATCH LINE
-  DEMO CONCRETE CURB & GUTTER (VERIFY IF GUTTER IS PRESENT UNDER EXISTING AC)

DEMOLITION NOTES

- ① SALVAGE CONC PLANTERS
- ② DEMO EX TREE

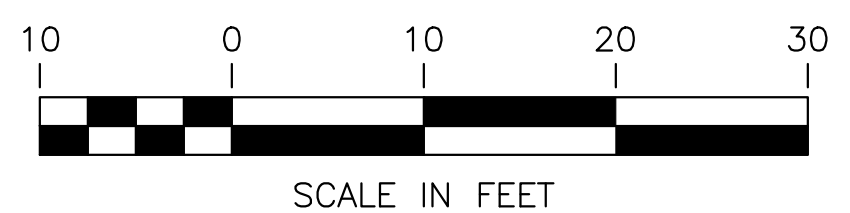
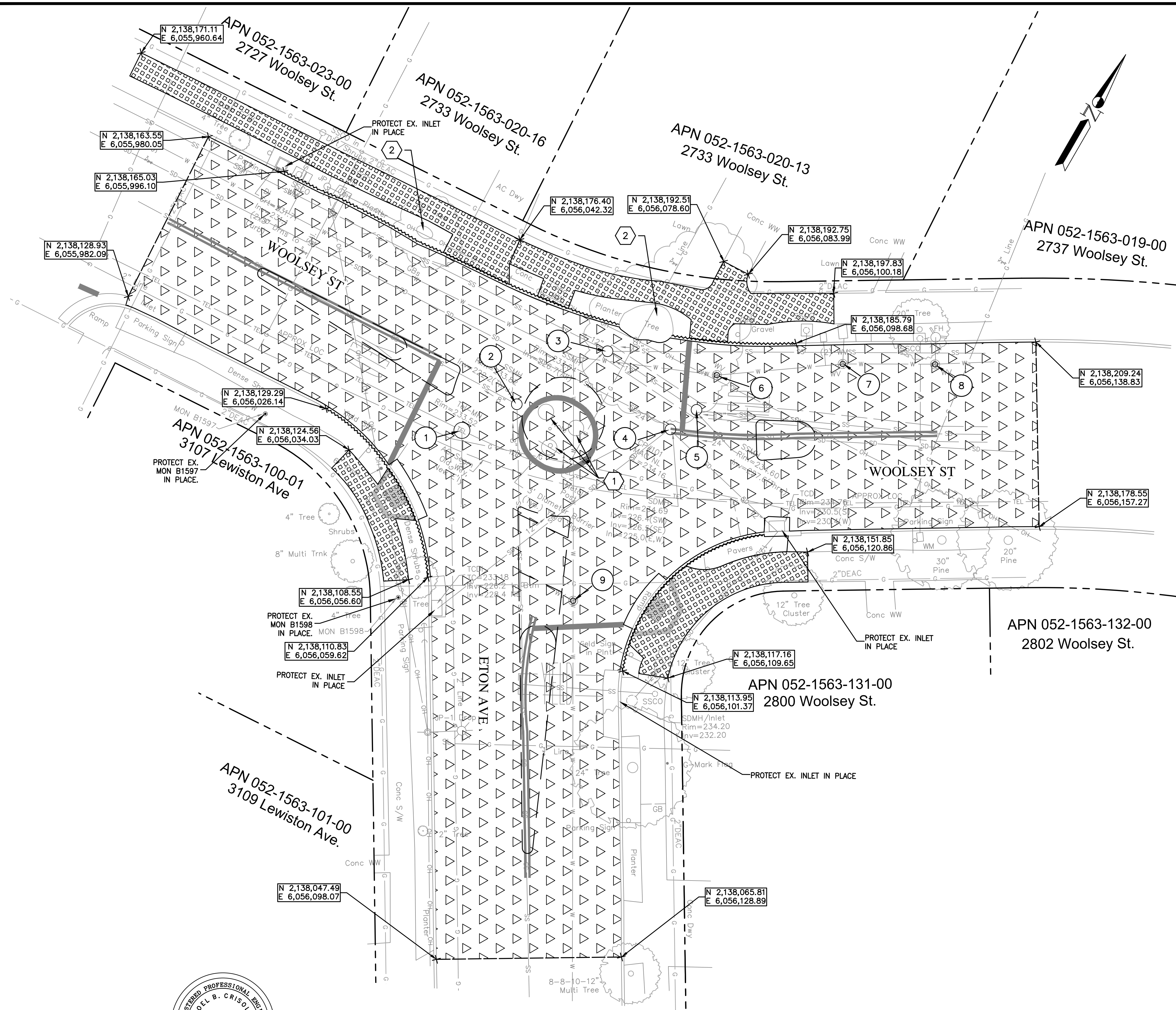

**L&C** ENGINEERING & SURVEYING, INC.  
 930 Estadillo Street  
 Marin, California 94053-1600  
 (925) 229-4218 Fax (925) 229-4638  
 www.lc-inc.com

PROJECT MANAGER: \_\_\_\_\_ DATE \_\_\_\_\_  
 DEPICTION OF MONUMENTS: \_\_\_\_\_ DATE \_\_\_\_\_  
 SURVEY PARTY CHIEF \_\_\_\_\_ DATE \_\_\_\_\_  
 WATERSHED REVIEW: \_\_\_\_\_ DATE \_\_\_\_\_

SUBMITTED: \_\_\_\_\_ DATE \_\_\_\_\_  
 SUPERVISING CIVIL ENGINEER \_\_\_\_\_ DATE \_\_\_\_\_  
 APPROVED: \_\_\_\_\_ DATE \_\_\_\_\_  
 CITY ENGINEER \_\_\_\_\_ DATE \_\_\_\_\_

DESIGN: **MMV**  
 DRAWN: **NBC**  
 CHECK: **CMF**  
 AS BUILT: \_\_\_\_\_

HORIZ. \_\_\_\_\_  
 VERT. \_\_\_\_\_  
 BOOK \_\_\_\_\_  
 DATE: **03/22/24**

**CITY OF BERKELEY**  
 DEPARTMENT OF PUBLIC WORKS

**PEDESTRIAN IMPROVEMENTS AT INTERSECTION OF WOOLSEY STREET AT ETON AVE**  
**DEMOLITION & UTILITY ADJUSTMENT PLAN**

PLAN **8276**  
 FILE **503-635**  
 EX-1  
 SHEET **3** OF **10**

REVISION	MARK	DATE	DESCRIPTION	APPROVAL

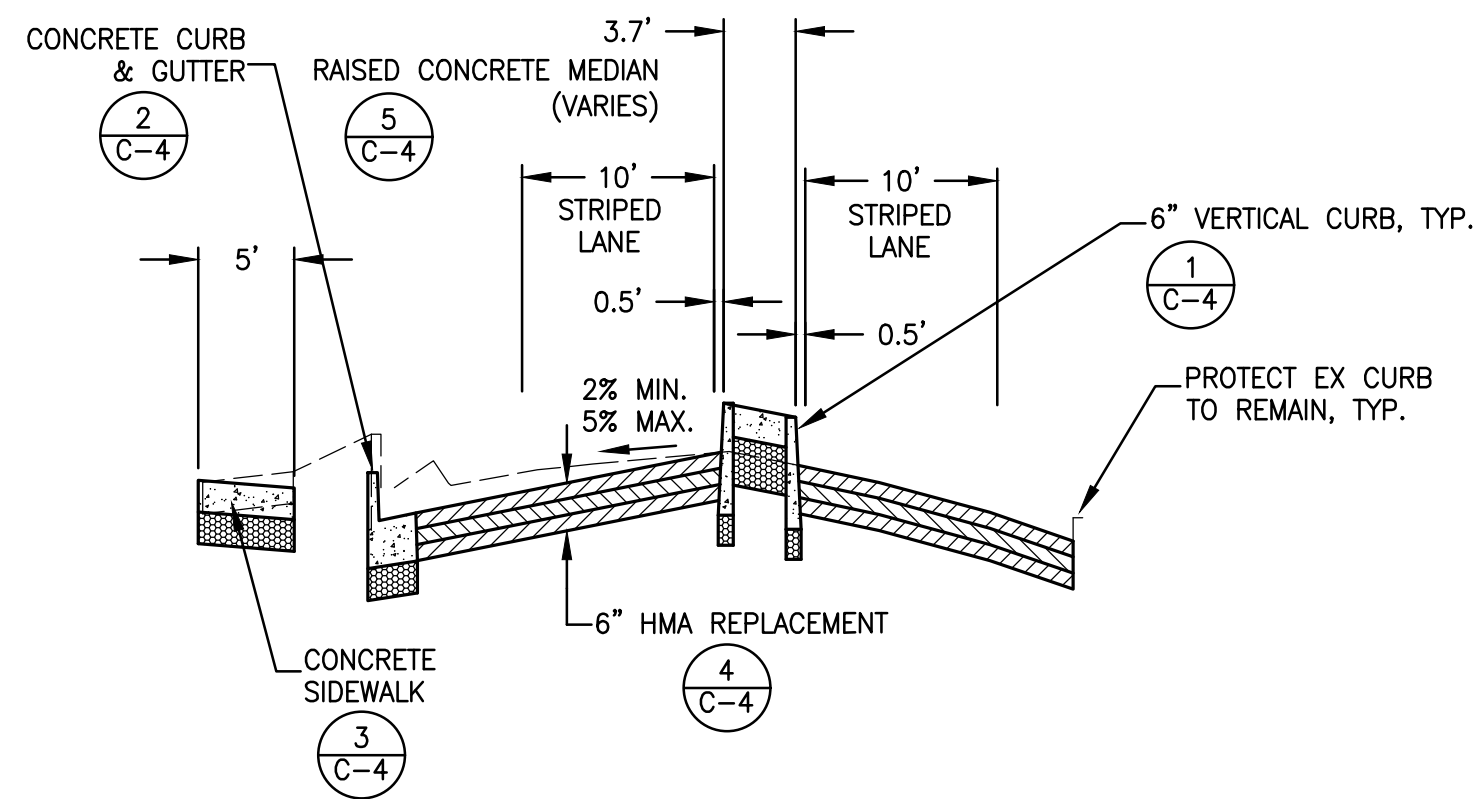

**A**  
**TS-1**  
**TYPICAL SECTION**  
SCALE: 1"=10' HORIZ  
1"=2' VERT

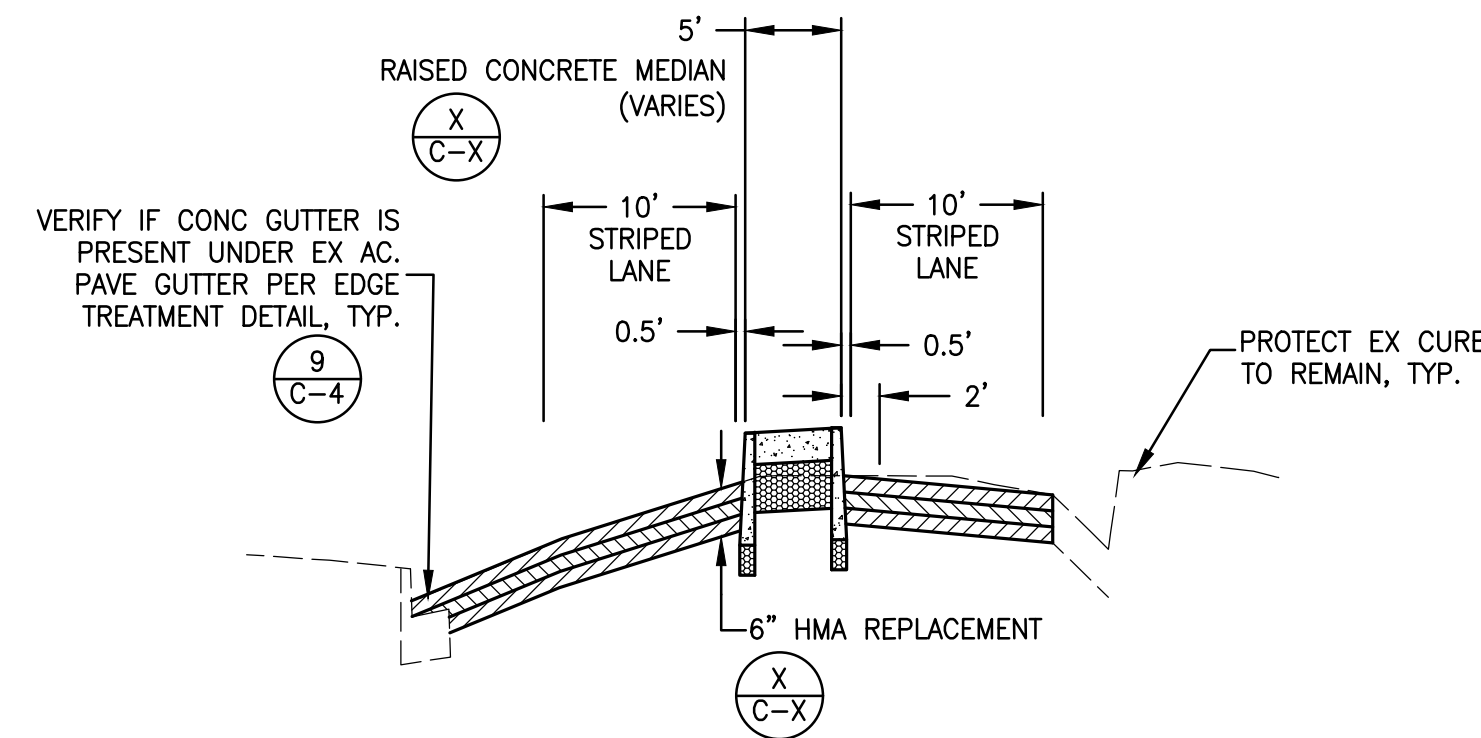

**D**  
**TS-1**  
**TYPICAL SECTION**  
SCALE: 1"=10' HORIZ  
1"=2' VERT

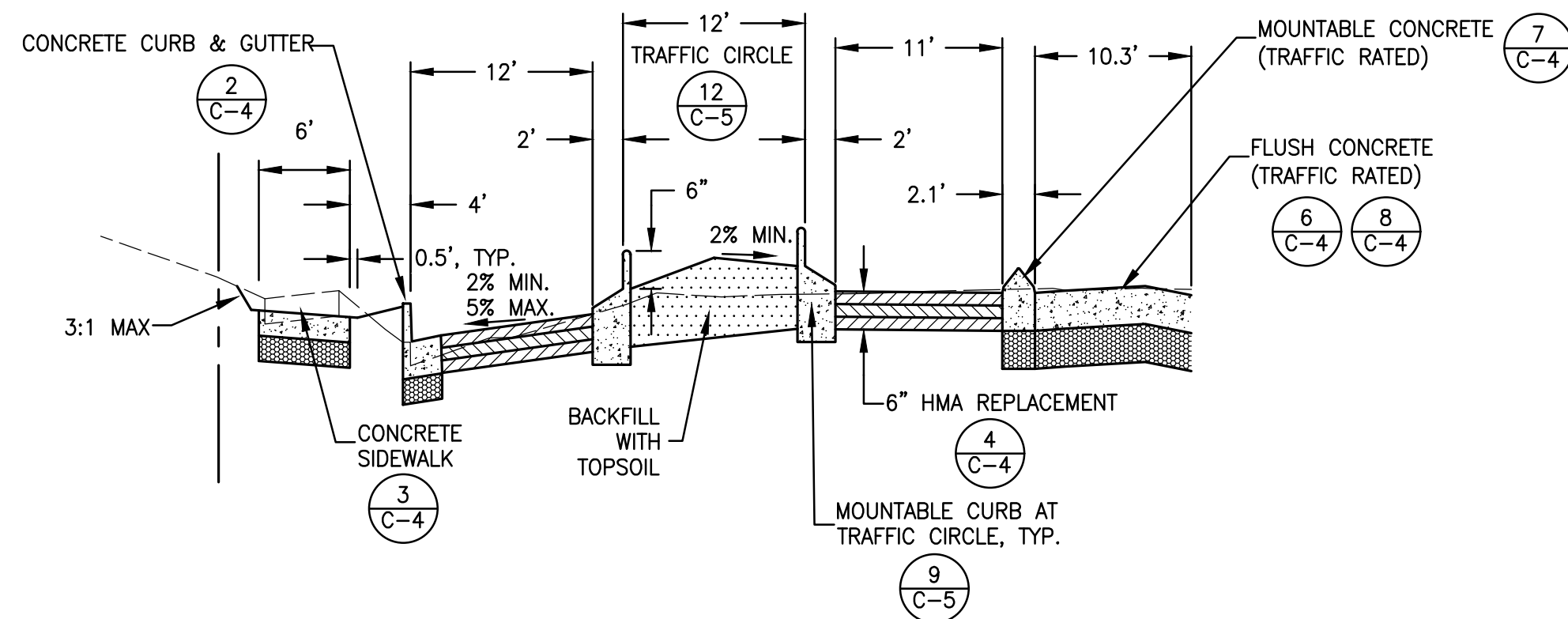

**B**  
**TS-1**  
**TYPICAL SECTION**  
SCALE: 1"=10' HORIZ  
1"=2' VERT

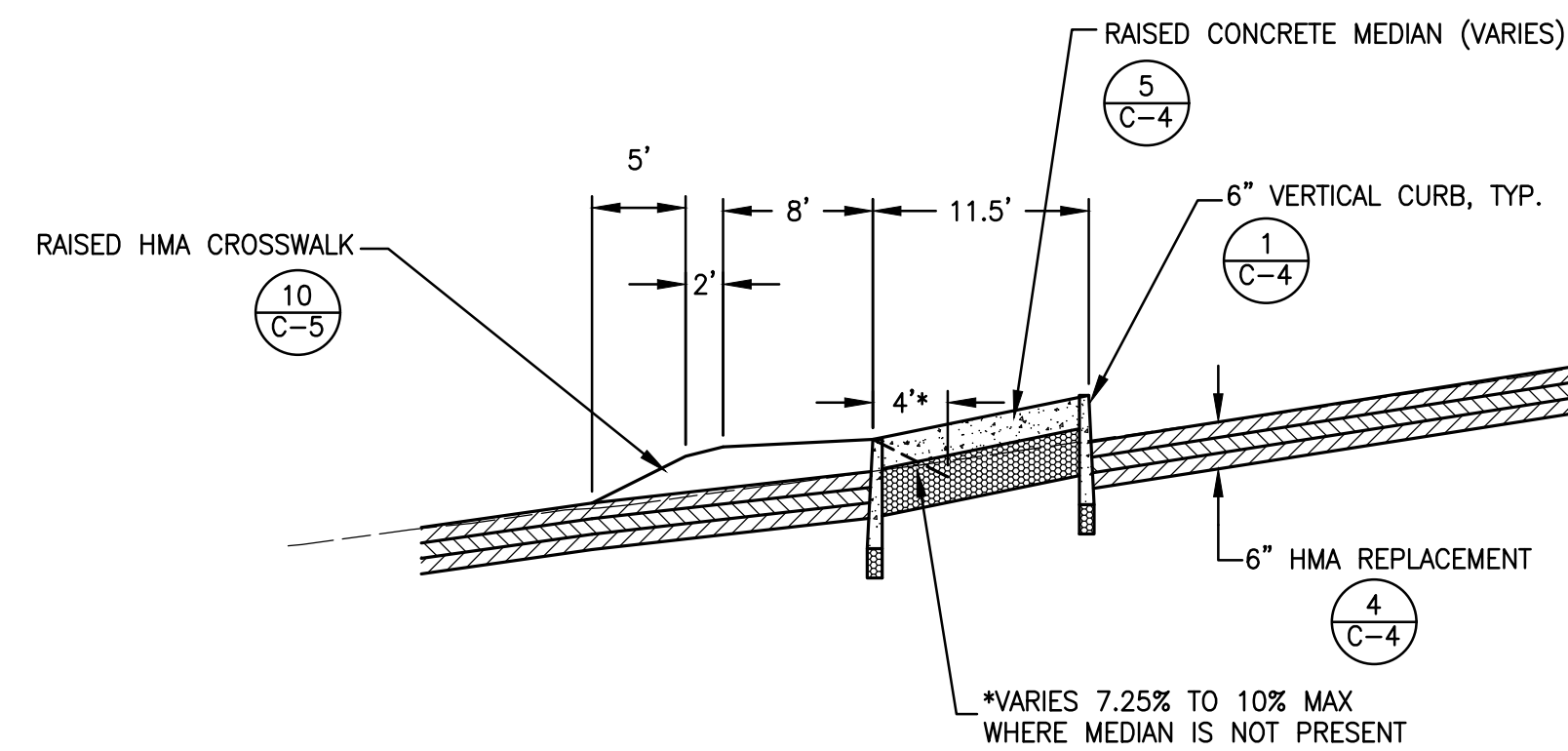

**E**  
**TS-1**  
**TYPICAL SECTION**  
SCALE: 1"=10' HORIZ  
1"=2' VERT

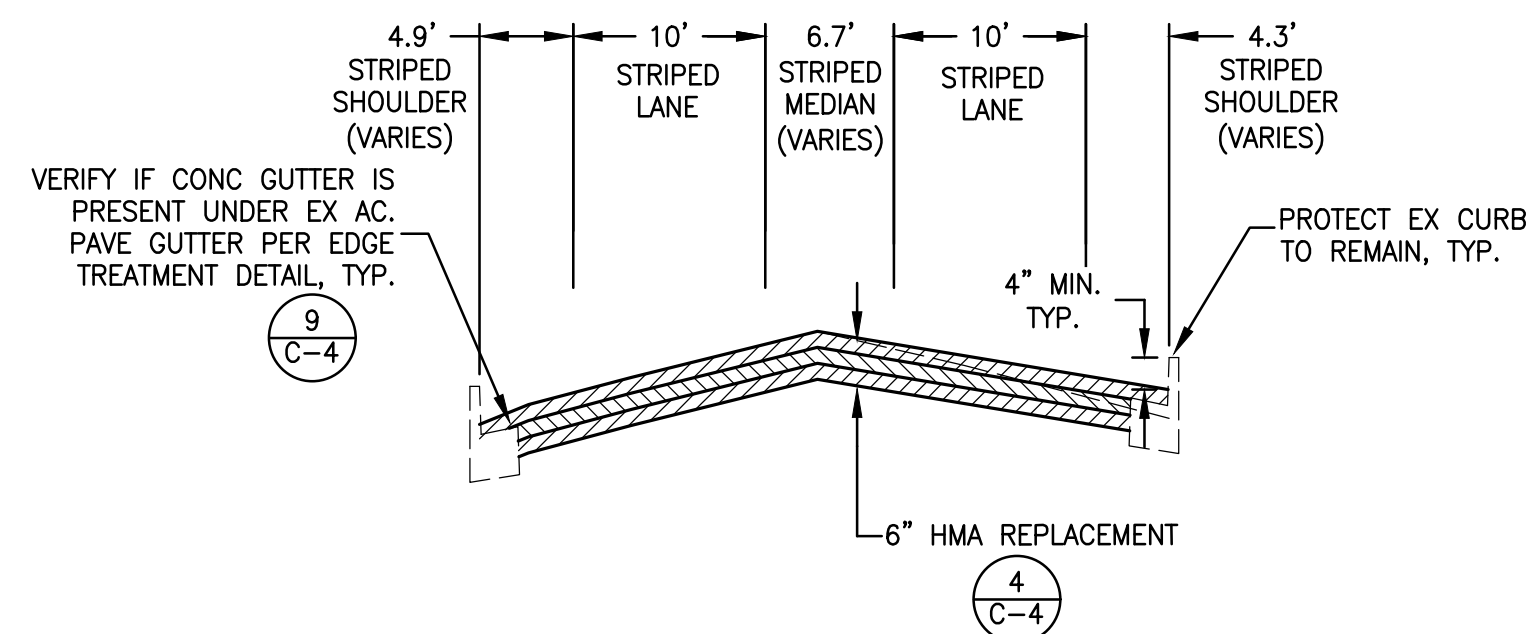

**C**  
**TS-1**  
**TYPICAL SECTION**  
SCALE: 1"=10' HORIZ  
1"=2' VERT



**L&C** ENGINEERING & SURVEYING, INC.  
930 Estudillo Street  
Martinez, California 94553-1620  
(925) 229-4218 Fax (925) 229-4638  
www.l-c-inc.com

PROJECT MANAGER: \_\_\_\_\_ DATE \_\_\_\_\_  
DEPICTION OF MONUMENTS: \_\_\_\_\_ DATE \_\_\_\_\_  
SURVEY PARTY CHIEF \_\_\_\_\_  
WATERSHED REVIEW: \_\_\_\_\_ DATE \_\_\_\_\_

SUBMITTED: \_\_\_\_\_ DATE \_\_\_\_\_  
SUPERVISING CIVIL ENGINEER \_\_\_\_\_  
APPROVED: \_\_\_\_\_ DATE \_\_\_\_\_  
CITY ENGINEER \_\_\_\_\_

DESIGN **MMV**  
DRAWN **NBC**  
CHECK **CMP**  
AS BUILT \_\_\_\_\_

HORIZ. \_\_\_\_\_  
VERT. \_\_\_\_\_  
BOOK \_\_\_\_\_  
DATE **03/22/24**

**CITY OF BERKELEY**  
DEPARTMENT OF PUBLIC WORKS

**PEDESTRIAN IMPROVEMENTS AT INTERSECTION OF WOOLSEY STREET AT ETON AVE**  
**TYPICAL SECTIONS**

PLAN **8276**  
FILE **503-635**  
**TS-1**  
SHEET **4** OF **10**

REVISION	MARK	DATE	DESCRIPTION	APPROVAL







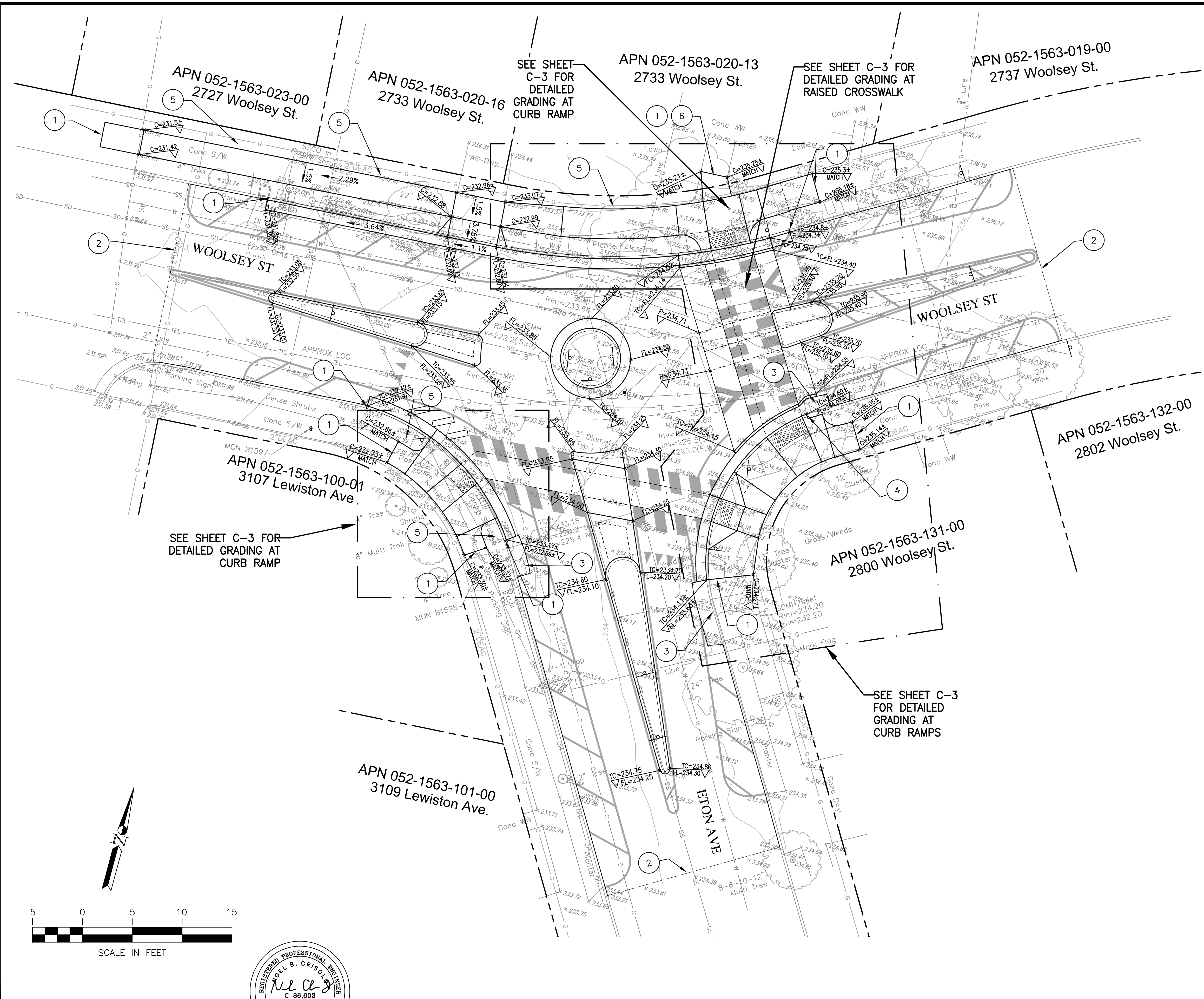

**GRADING NOTES**

1. SEE SHEET C-3 FOR DETAILED GRADING AT CURB RAMPS AND RAISED CROSSWALK.
2. AT EXISTING CURB TO REMAIN, MINIMUM 4" SHALL BE EXPOSED. ENSURE POSITIVE DRAINAGE ALONG FLOWLINE OF CURB.
3. NEW CURB AND GUTTER SHALL BE 6" IN HEIGHT PER CITY STANDARD DETAIL, UNLESS OTHERWISE SHOWN AT CURB RAMPS.

**GRADING LEGEND**

- GRADEBREAK, TYP.
- ▲ ELEV GRADE FLAG

**GRADING DETAIL NUMBERED NOTES:**

- 1 SAWCUT & MATCH AT NEAREST JOINT, OR AS DIRECTED BY ENGINEER. DOWELL TO EXISTING, TYP.
- 2 SAWCUT & MATCH EXISTING PAVEMENT (MATCH GRADE).
- 3 PROTECT EXISTING INLET.
- 4 SAWCUT & MATCH AT BACK OF CURB (OR EDGE OF INLET BOX, AS DIRECTED).
- 5 REPAIR/RESTORE DAMAGE TO EXISTING LANDSCAPE PLANTER AREA WITH IN KIND PLANTS AND MULCH. RELOCATE ANY IRRIGATION HEADS AND LINES AS REQUIRED.
- 6 RECONSTRUCT PRIVATE WALKWAY TO CONFORM TO NEW BACK OF PUBLIC SIDEWALK. MATCH EXISTING WALKWAY IN STRUCTURAL THICKNESS, COLOR, AND SCORE LINE PATTERNS.

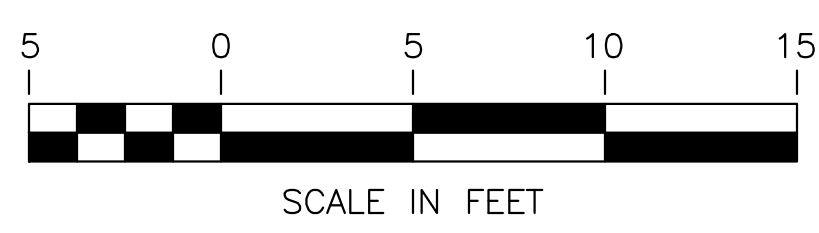

**L&C** ENGINEERING & SURVEYING, INC.  
 930 Estudillo Street  
 Marina, California 94033-1600  
 (925) 228-4218 Fax (925) 228-4638  
 www.lc-inc.com

PROJECT MANAGER: \_\_\_\_\_ DATE \_\_\_\_\_  
 SURVEY PARTY CHIEF \_\_\_\_\_ DATE \_\_\_\_\_  
 WATERSHED REVIEW: \_\_\_\_\_ DATE \_\_\_\_\_

DEPICTION OF MONUMENTS: \_\_\_\_\_ DATE \_\_\_\_\_  
 SUBMITTED: \_\_\_\_\_ DATE \_\_\_\_\_  
 SUPERVISING CIVIL ENGINEER: \_\_\_\_\_ DATE \_\_\_\_\_  
 APPROVED: \_\_\_\_\_ DATE \_\_\_\_\_  
 CITY ENGINEER: \_\_\_\_\_ DATE \_\_\_\_\_

DESIGN: **MMV**  
 DRAWN: **NBC**  
 CHECK: **CMP**  
 AS BUILT: \_\_\_\_\_

HORIZ. \_\_\_\_\_  
 VERT. \_\_\_\_\_  
 BOOK \_\_\_\_\_  
 DATE: **03/22/24**

**CITY OF BERKELEY**  
 DEPARTMENT OF PUBLIC WORKS

**PEDESTRIAN IMPROVEMENTS AT INTERSECTION OF WOOLSEY STREET AT ETON AVE**  
**GRADING PLAN**

PLAN **8276**  
 FILE **503-635**  
 C-2  
 SHEET **6** OF **10**

REVISION	MARK	DATE	DESCRIPTION	APPROVAL



**CURB RAMP NOTES:**

1. ALL CURB RAMP SHALL CONFORM TO CALTRANS 2022 STANDARD PLAN A88A, AND MODIFIED AS SHOWN ON PLANS
2. CURB RAMP SECTION SHALL CONFORM TO CITY SIDEWALK DETAIL (SEE DETAIL 3/C-4) AND SHALL BE 4" CONCRETE OVER 4" AB.
3. CURB RAMP LIMITS FOR ESTIMATING PURPOSES SHALL BE AS SHOWN ON THE PLANS WHICH INCLUDES CURB RAMP LANDINGS, RAMPS, RETAINING CURBS AND LIMITED SIDEWALK CONFORMS.

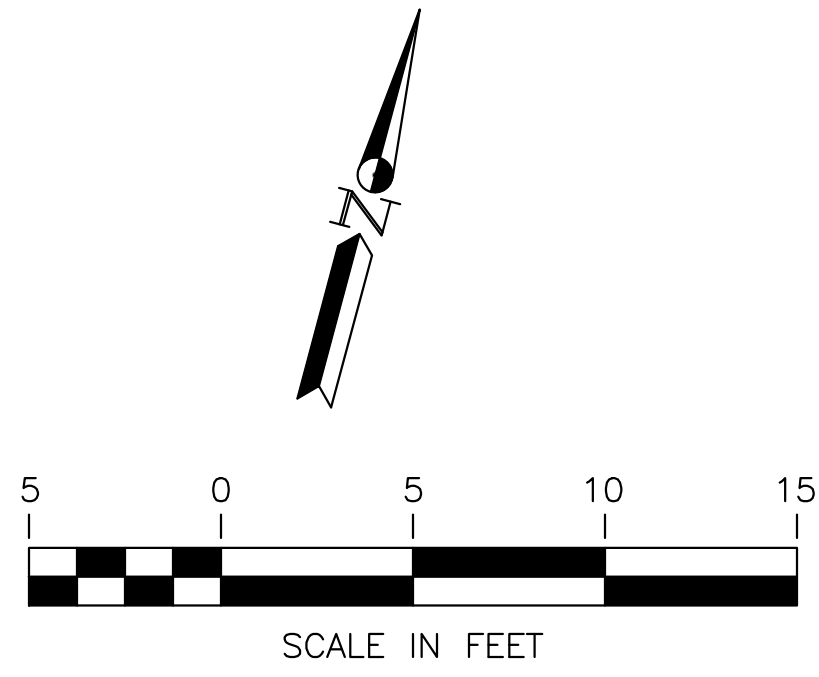
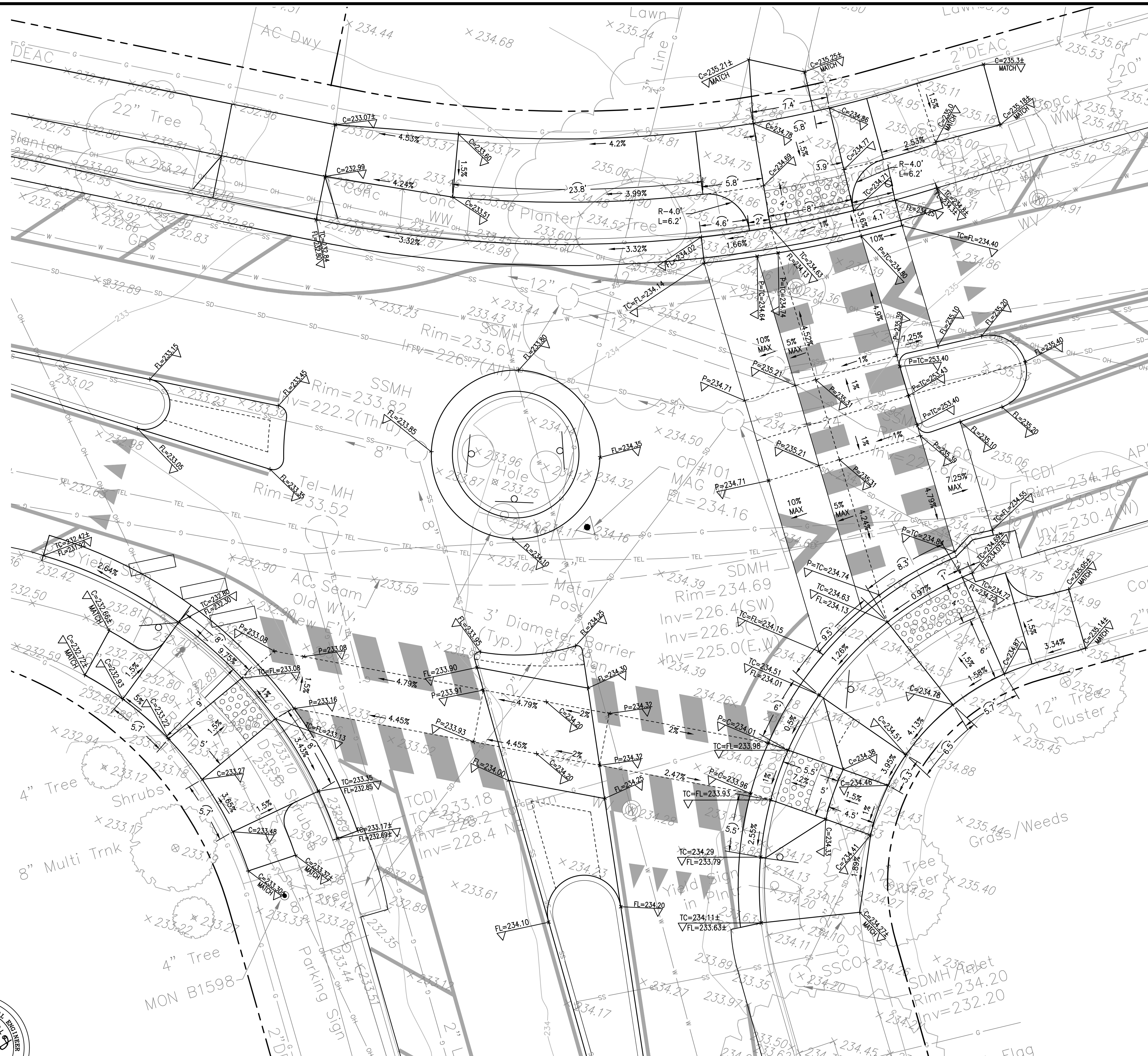

**L&C ENGINEERING & SURVEYING, INC.**  
 930 Estudillo Street  
 Marina, California 94053-1600  
 (925) 228-4218 Fax (925) 228-4638  
 www.lc-enc.com

PROJECT MANAGER: \_\_\_\_\_ DATE \_\_\_\_\_  
 SURVEY PARTY CHIEF \_\_\_\_\_ DATE \_\_\_\_\_  
 WATERSHED REVIEW: \_\_\_\_\_ DATE \_\_\_\_\_

DEPICTION OF MONUMENTS: \_\_\_\_\_ DATE \_\_\_\_\_  
 SUBMITTED: \_\_\_\_\_ DATE \_\_\_\_\_  
 SUPERVISING CIVIL ENGINEER: \_\_\_\_\_ DATE \_\_\_\_\_  
 APPROVED: \_\_\_\_\_ DATE \_\_\_\_\_  
 CITY ENGINEER: \_\_\_\_\_ DATE \_\_\_\_\_

DESIGN: **MMV**  
 DRAWN: **NBC**  
 CHECK: **CMP**  
 AS BUILT: \_\_\_\_\_  
 HORIZ. \_\_\_\_\_  
 VERT. \_\_\_\_\_  
 BOOK \_\_\_\_\_  
 DATE: **03/22/24**

**CITY OF BERKELEY**  
 DEPARTMENT OF PUBLIC WORKS

**PEDESTRIAN IMPROVEMENTS AT INTERSECTION OF WOOLSEY STREET AT ETON AVE**  
**DETAILED GRADING FOR CURB RAMPS & RAISED CROSSWALK**

PLAN **8276**  
 FILE **503-635**  
**C-3**  
 SHEET **7** OF **10**

REVISION	MARK	DATE	DESCRIPTION	APPROVAL



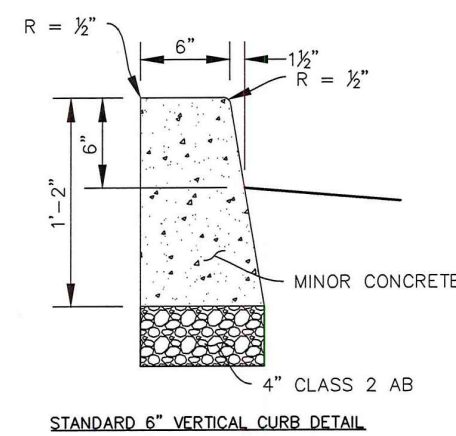

NOTE:  
1. FOR ADDITIONAL REQUIREMENTS, SEE PLAN 8144, "CONCRETE WORK NOTES."

STANDARD DETAIL VERTICAL CONCRETE CURB	SUBMITTED: <i>D. Z. R. by</i>	DATE: 2/27/17	CITY OF BERKELEY		
	SUPERVISING CIVIL ENGINEER	R.C.E. 64502	DEPARTMENT OF PUBLIC WORKS		
	APPROVED: <i>P. L. O.</i>	DATE: 2/28/17	DESIGN: HEI	DATE: 01/26/17	PLAN: 8146
	MANAGER OF ENGINEERING	R.C.E. 66014	DRAWN: HEI	SCALE: N.T.S.	FILE: 208-158
			CHECK: MS	BOOK:	SHEET: 1 OF 1

1 VERTICAL CURB  
N.T.S.

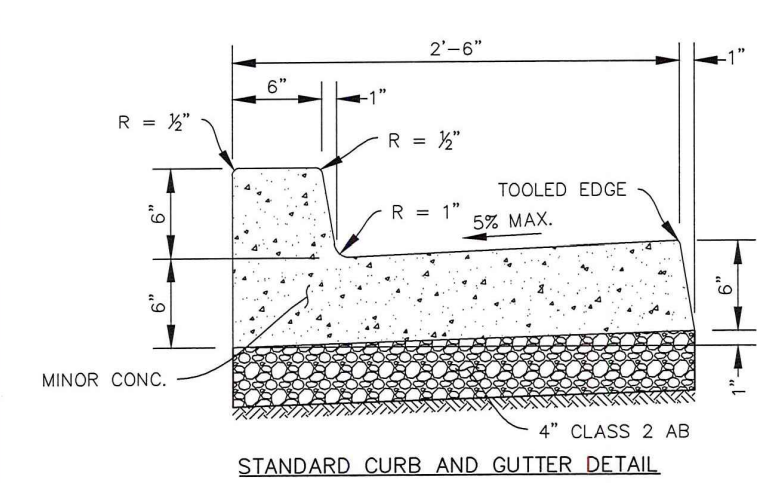

NOTE:  
1. FOR ADDITIONAL REQUIREMENTS, SEE PLAN 8144, "CONCRETE WORK NOTES."

STANDARD DETAIL CURB AND GUTTER	SUBMITTED: <i>D. Z. R. by</i>	DATE: 2/27/17	CITY OF BERKELEY		
	SUPERVISING CIVIL ENGINEER	R.C.E. 64502	DEPARTMENT OF PUBLIC WORKS		
	APPROVED: <i>P. L. O.</i>	DATE: 2/28/17	DESIGN: HEI	DATE: 01/26/17	PLAN: 8146
	MANAGER OF ENGINEERING	R.C.E. 66014	DRAWN: HEI	SCALE: N.T.S.	FILE: 208-157
			CHECK: MS	BOOK:	SHEET: 1 OF 1

2 CURB AND GUTTER  
N.T.S.

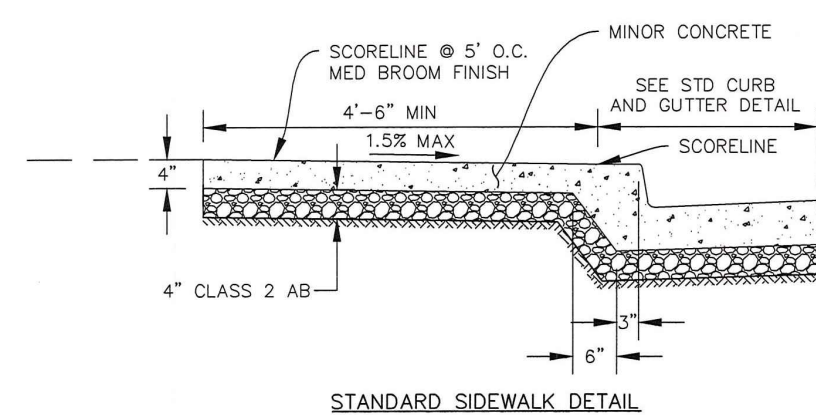

STANDARD SIDEWALK DETAIL

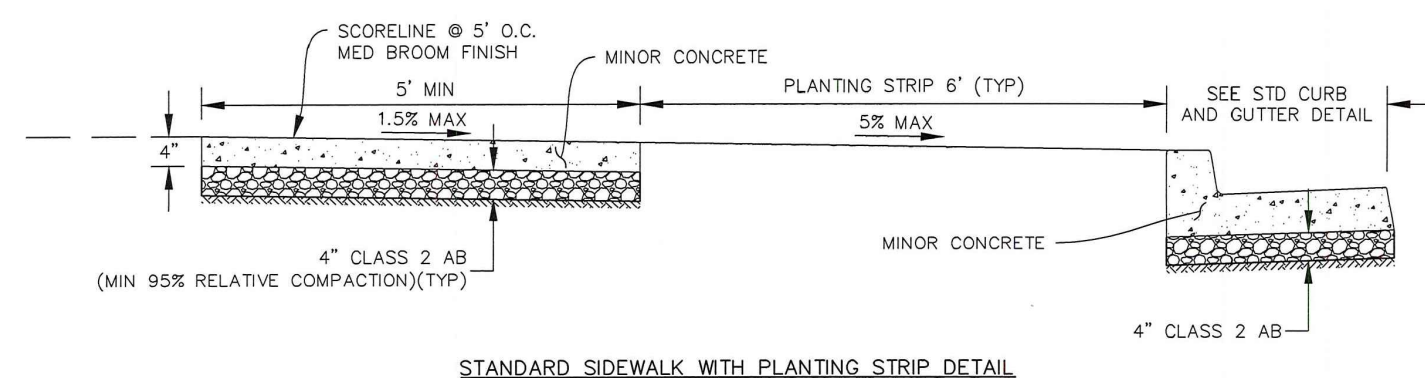

STANDARD SIDEWALK WITH PLANTING STRIP DETAIL

NOTE:  
1. FOR ADDITIONAL REQUIREMENTS, SEE PLAN 8144, "CONCRETE WORK NOTES."

STANDARD DETAIL SIDEWALK	SUBMITTED: <i>D. Z. R. by</i>	DATE: 2/27/17	CITY OF BERKELEY		
	SUPERVISING CIVIL ENGINEER	R.C.E. 64502	DEPARTMENT OF PUBLIC WORKS		
	APPROVED: <i>P. L. O.</i>	DATE: 2/28/17	DESIGN: HEI	DATE: 01/26/17	PLAN: 8153
	MANAGER OF ENGINEERING	R.C.E. 66014	DRAWN: HEI	SCALE: N.T.S.	FILE: 208-165
			CHECK: MS	BOOK:	SHEET: 1 OF 1

3 CONCRETE SIDEWALK  
N.T.S.



03/22/24

L&C ENGINEERING & SURVEYING, INC.  
930 Estudillo Street  
Marina, California 94033-1620  
(925) 229-4218 Fax (925) 229-4638  
www.lc-enc.com

PROJECT MANAGER: \_\_\_\_\_ DATE \_\_\_\_\_  
DEPICTION OF MONUMENTS: \_\_\_\_\_ DATE \_\_\_\_\_  
SURVEY PARTY CHIEF: \_\_\_\_\_  
WATERSHED REVIEW: \_\_\_\_\_ DATE \_\_\_\_\_

SUBMITTED: \_\_\_\_\_ DATE \_\_\_\_\_  
R.C.E. \_\_\_\_\_  
EXP. \_\_\_\_\_  
SUPERVISING CIVIL ENGINEER  
APPROVED: \_\_\_\_\_ DATE \_\_\_\_\_  
R.C.E. \_\_\_\_\_  
EXP. \_\_\_\_\_  
CITY ENGINEER

DESIGN: MMV  
DRAWN: NBC  
CHECK: CMP  
AS BUILT: \_\_\_\_\_  
DATE: 03/22/24

HORIZ. \_\_\_\_\_  
VERT. \_\_\_\_\_  
BOOK \_\_\_\_\_  
DATE: 03/22/24

CITY OF BERKELEY  
DEPARTMENT OF PUBLIC WORKS

PEDESTRIAN IMPROVEMENTS AT INTERSECTION  
OF WOOLSEY STREET AT ETON AVE  
CIVIL CONSTRUCTION DETAILS

PLAN 8276  
FILE 503-635  
C-4  
SHEET 8 OF 10

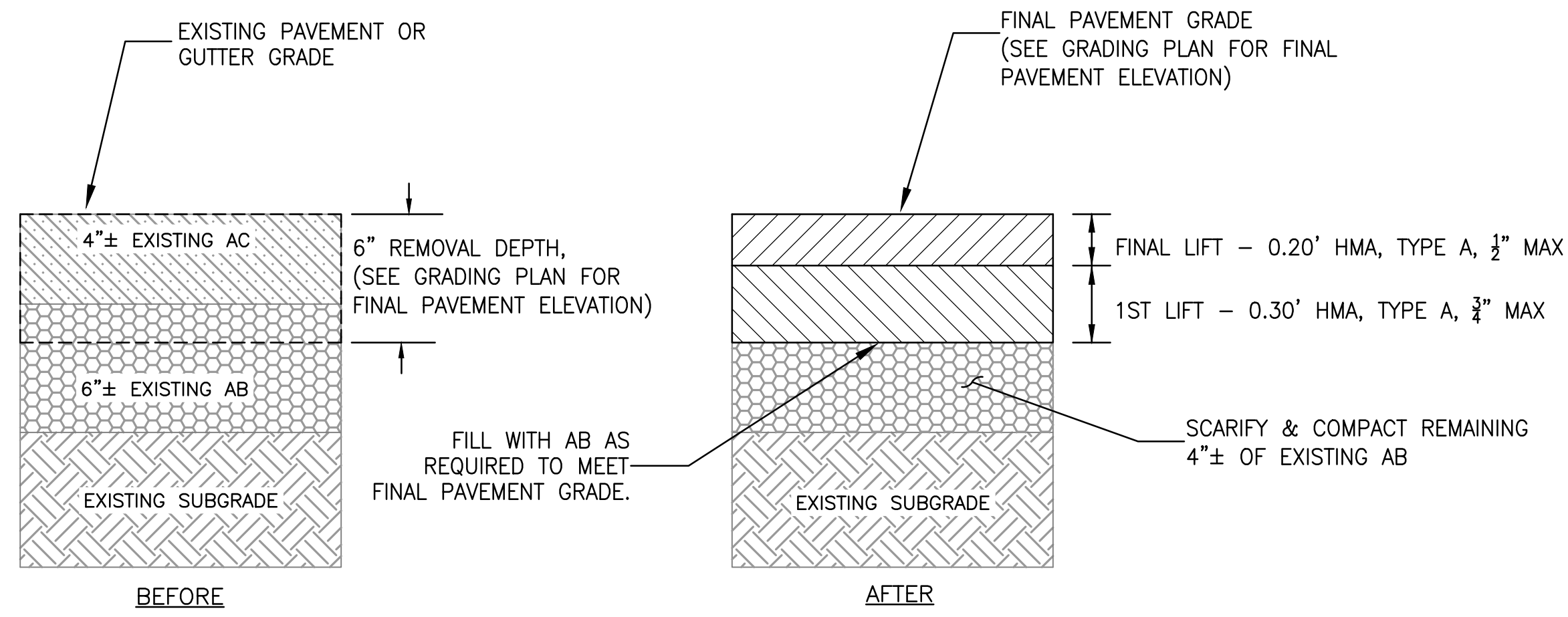

4 6" HMA REPLACEMENT  
N.T.S.

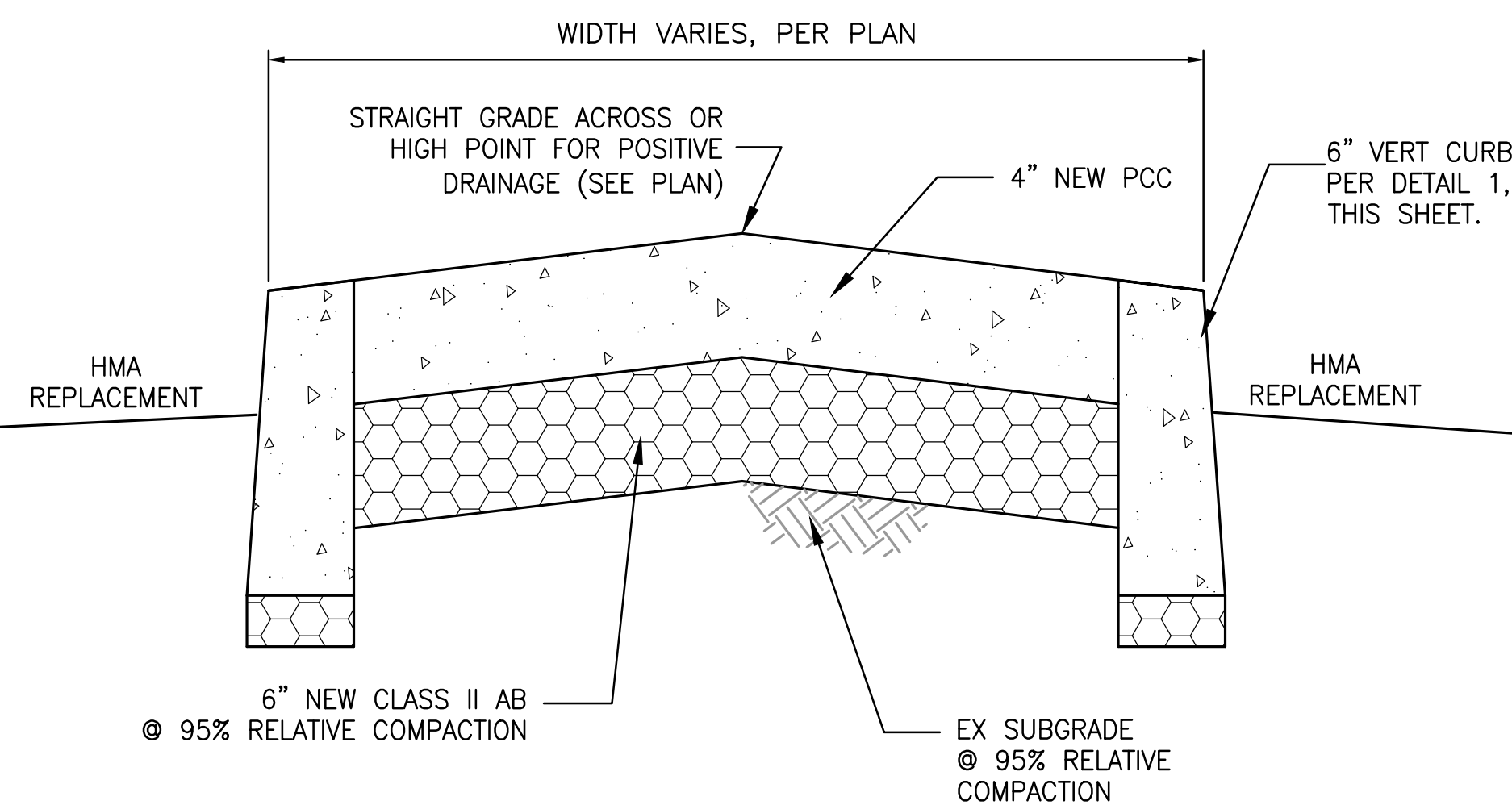

NOTES  
1. MINOR CONCRETE PER CONCRETE NOTES ON SHEET G-1.  
2. FOR CONTROL JOINTS AND EXPANSION JOINTS, SEE CONCRETE CONSTRUCTION NOTES ON SHEET G-1.

5 RAISED CONCRETE MEDIAN  
N.T.S.

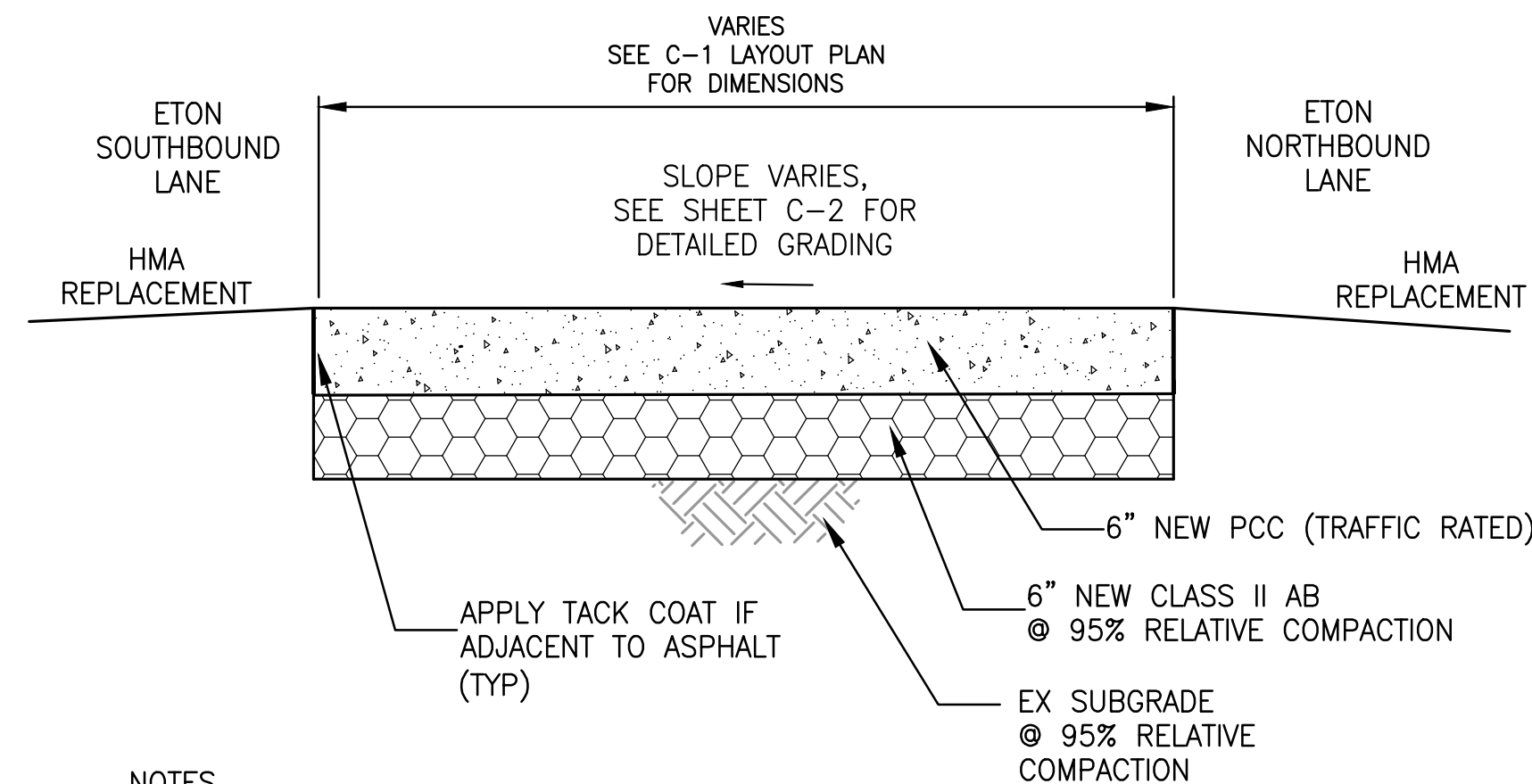

6 FLUSH CONCRETE MEDIAN (TRAFFIC RATED)  
N.T.S.

NOTES  
1. MINOR CONCRETE PER CONCRETE NOTES ON SHEET G-1.  
2. FOR CONTROL JOINTS AND EXPANSION JOINTS, SEE CONCRETE CONSTRUCTION NOTES ON SHEET G-1.  
3. SEE SHEET C-1 FOR LOCATION OF TRAFFIC RATED CONCRETE MEDIANS AND DETAIL 8 THIS SHEET.

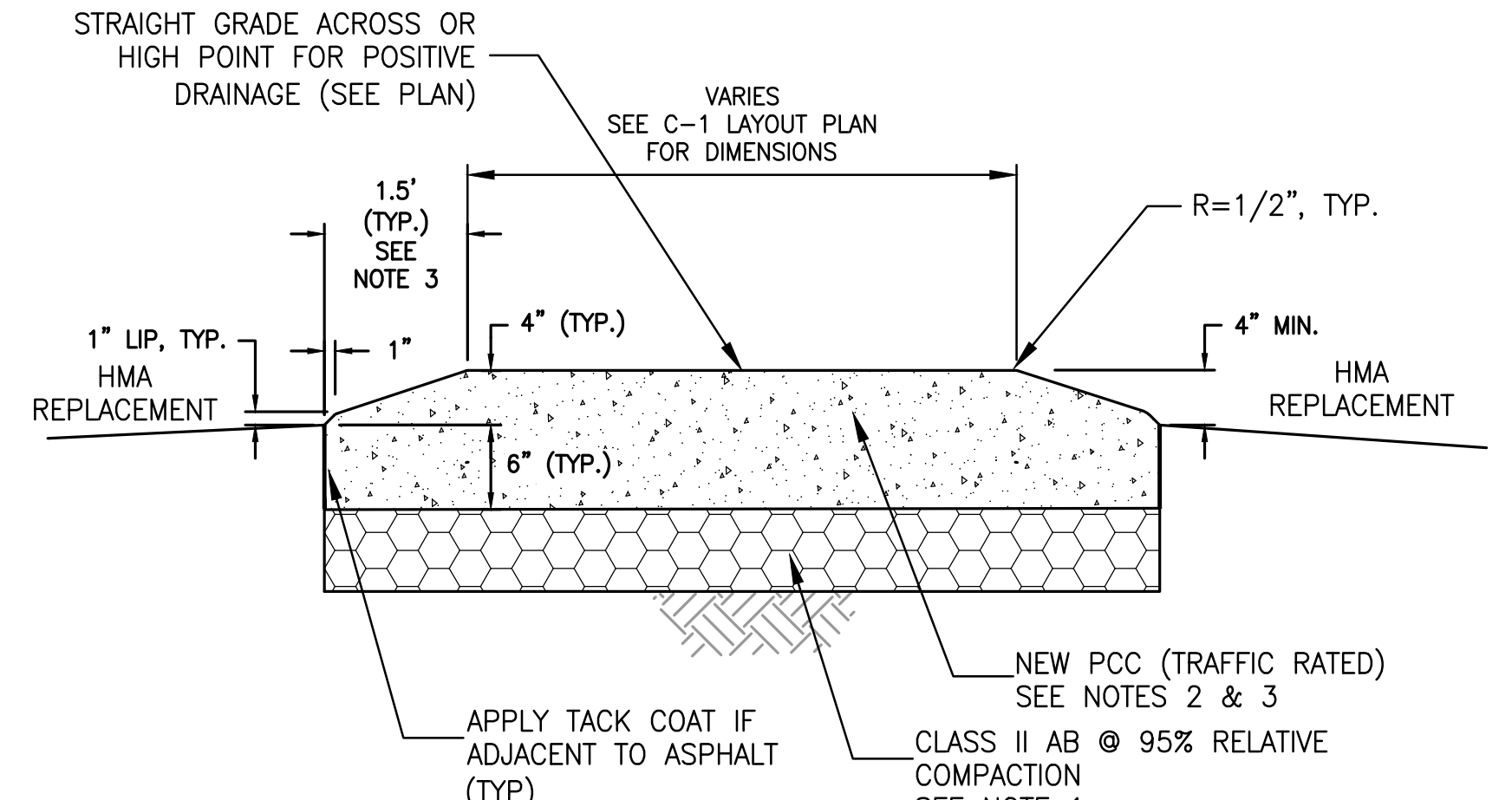

NOTES  
1. MINOR CONCRETE PER CONCRETE NOTES ON SHEET G-1.  
2. FOR CONTROL JOINTS AND EXPANSION JOINTS, SEE CONCRETE CONSTRUCTION NOTES ON SHEET G-1.  
3. WHEN TOTAL WIDTH IS LESS THAN 3', GRADE BREAK SHALL BE AT CENTER OF MEDIAN.

7 MOUNTABLE CONCRETE MEDIAN (TRAFFIC RATED)  
N.T.S.

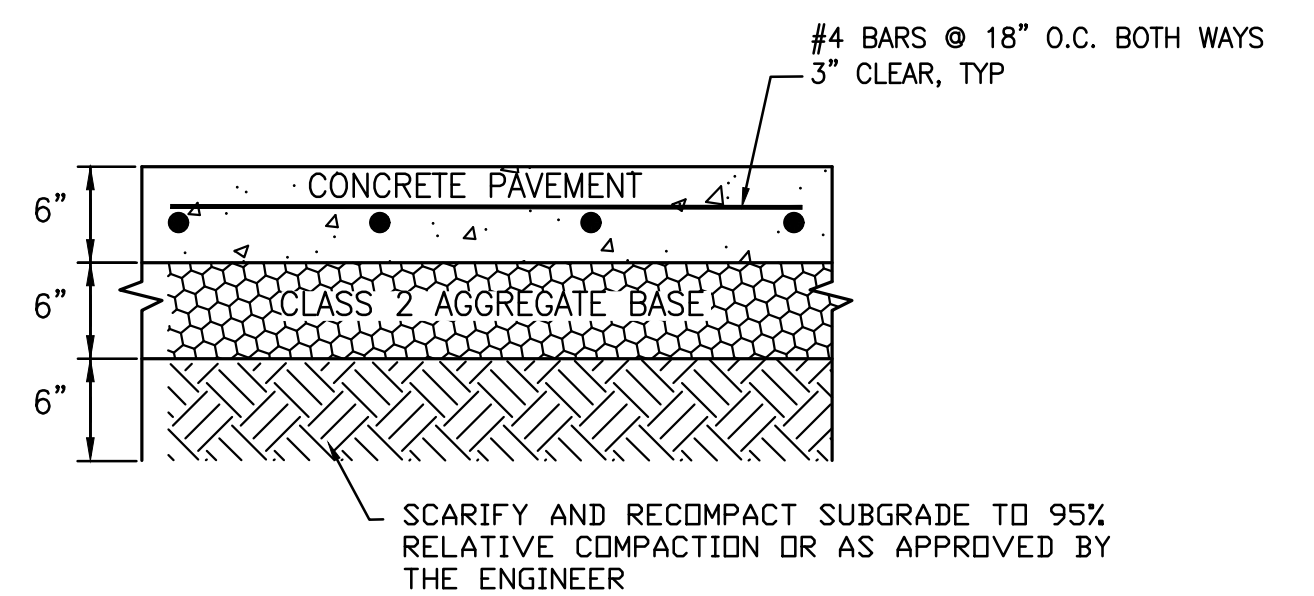

NOTES  
1. ALL TREAD SURFACES SHALL BE SLIP RESISTANT  
2. AS APPLICABLE, REUSE OF EXISTING BASEROCK SHALL BE APPROVED BY THE ENGINEER

8 TRAFFIC RATED CONCRETE FOR MOUNTABLE & FLUSH MEDIANS  
N.T.S.

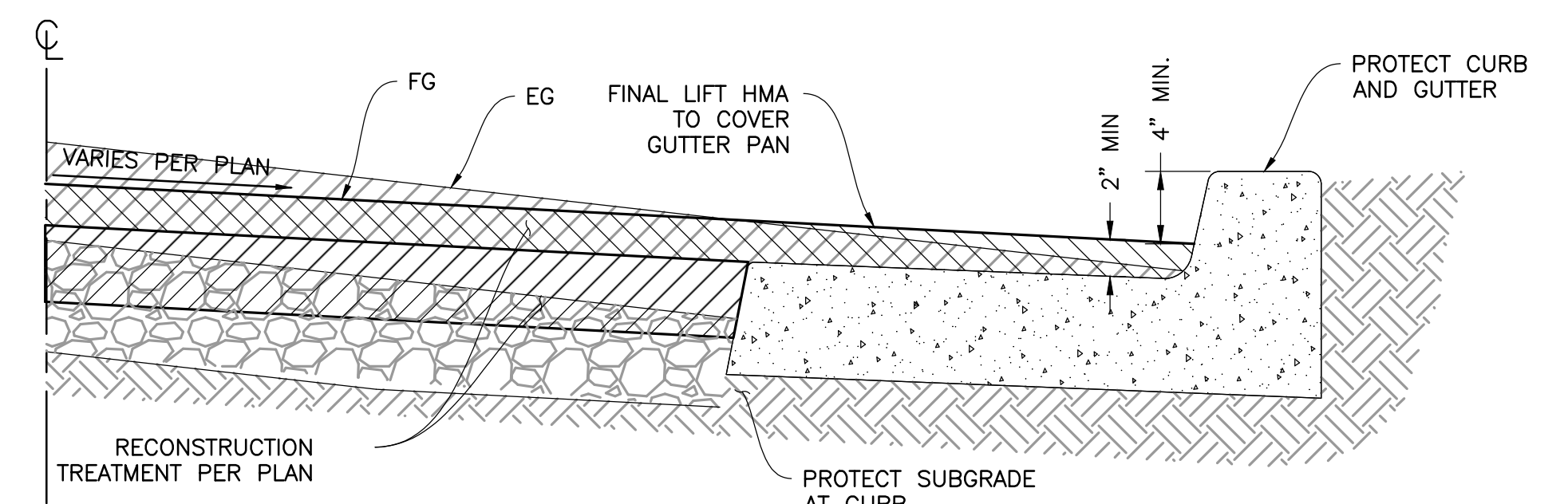

9 EDGE TREATMENT: EXISTING OVERLAPPED GUTTER PAN  
N.T.S.

APPROVAL	
DESCRIPTION	
DATE	
MARK	
REVISION	



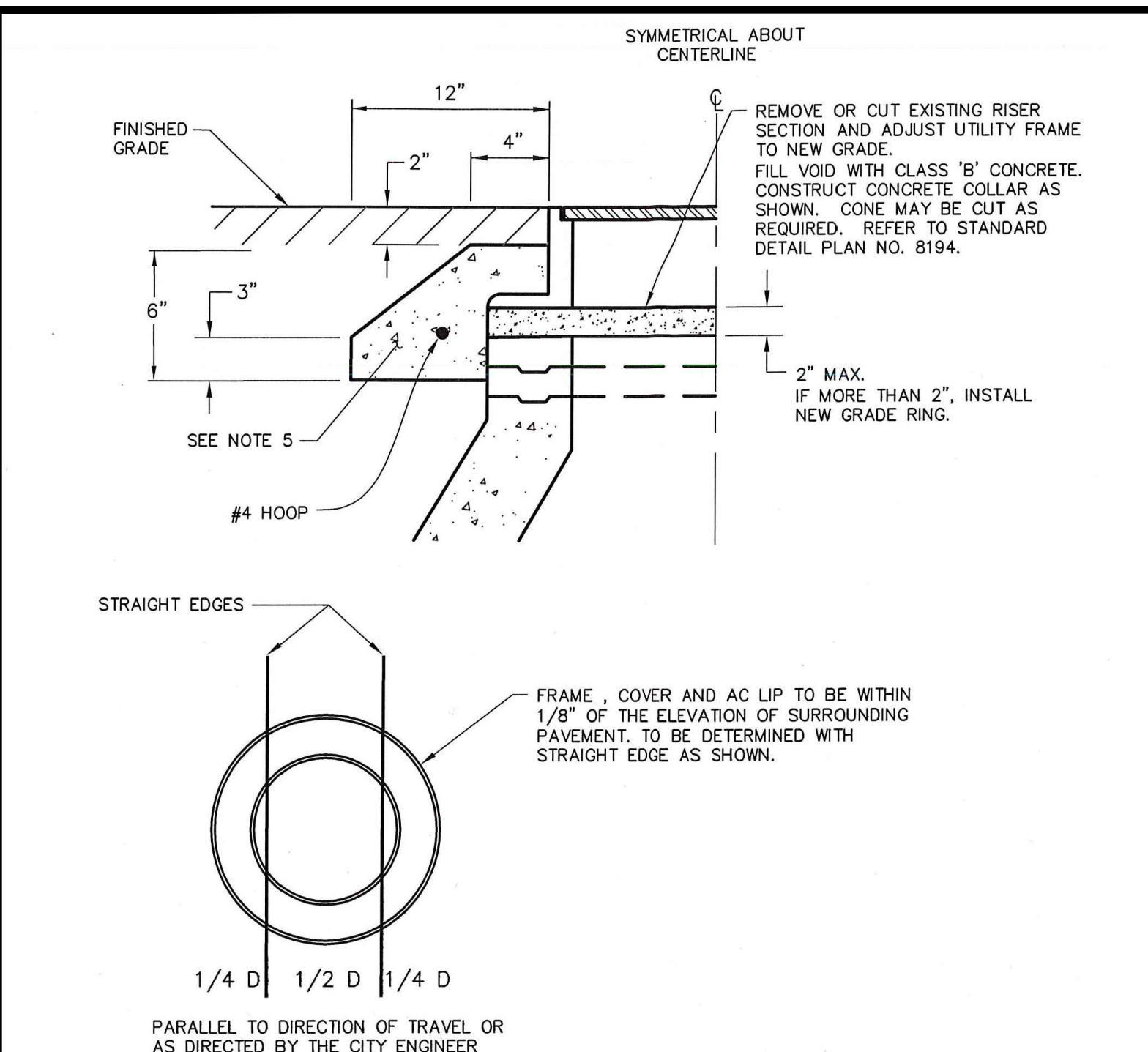

- NOTES:
- ALL SURFACE STRUCTURES EXTENDING 2" ABOVE THE NEW SUBGRADE OR MILLING PLANE SHALL BE LOWERED BY CONTRACTOR OR UTILITY OWNER TO THE NEW SUBGRADE BEFORE PAVING. STRUCTURES PROJECTING LESS THAN 2" ABOVE THE SUBGRADE MAY BE PAVED OVER AND LATER ADJUSTED TO GRADE.
  - ADJUST FRAME AND COVER TO FINISHED GRADE AFTER FINAL LIFT OF PAVING.
  - TRAFFIC CONTROL APPROVAL IS REQUIRED PRIOR TO ANY TRAFFIC LANE OBSTRUCTION.
  - PLACE TEMPORARY AC (CUT BACK) AROUND UTILITY FRAME UNTIL PERMANENT PAVING IS IN PLACED.
  - CAST-IN-PLACE CONCRETE COLLARS SHALL CONFORM TO STANDARD SPECIFICATIONS (GREENBOOK) SECTION 201-1.1.2 AND BE CLASS 560-B-3250.

DESIGN: TP	DATE: 5/23	PLAN: 8193	CITY OF BERKELEY DEPARTMENT OF PUBLIC WORKS STANDARD DETAIL
DRAWN: LG	SCALE: N.T.S.	FILE: 20B-169	
CHECK: KE	DATE: 5-23-11		

9 MAINTENANCE HOLE ADJUSTMENT  
N.T.S.

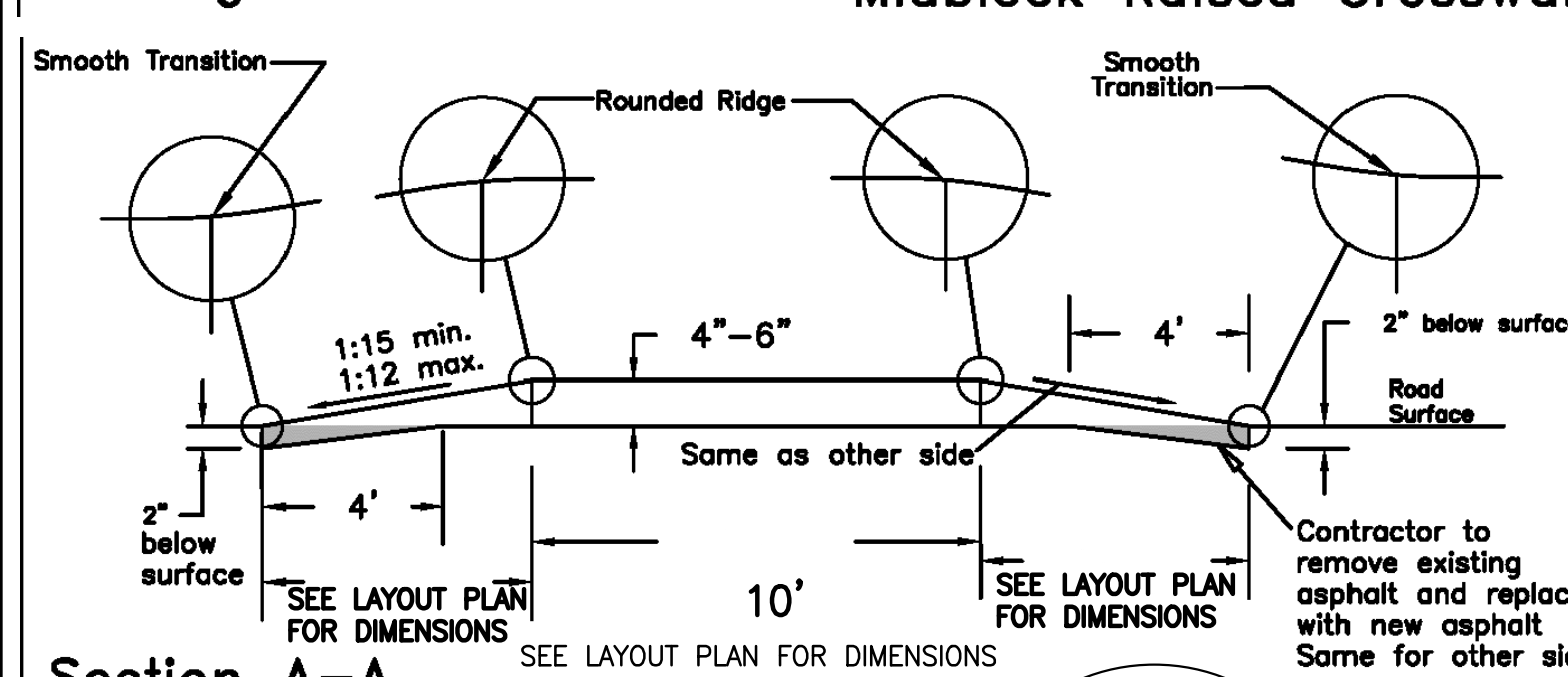
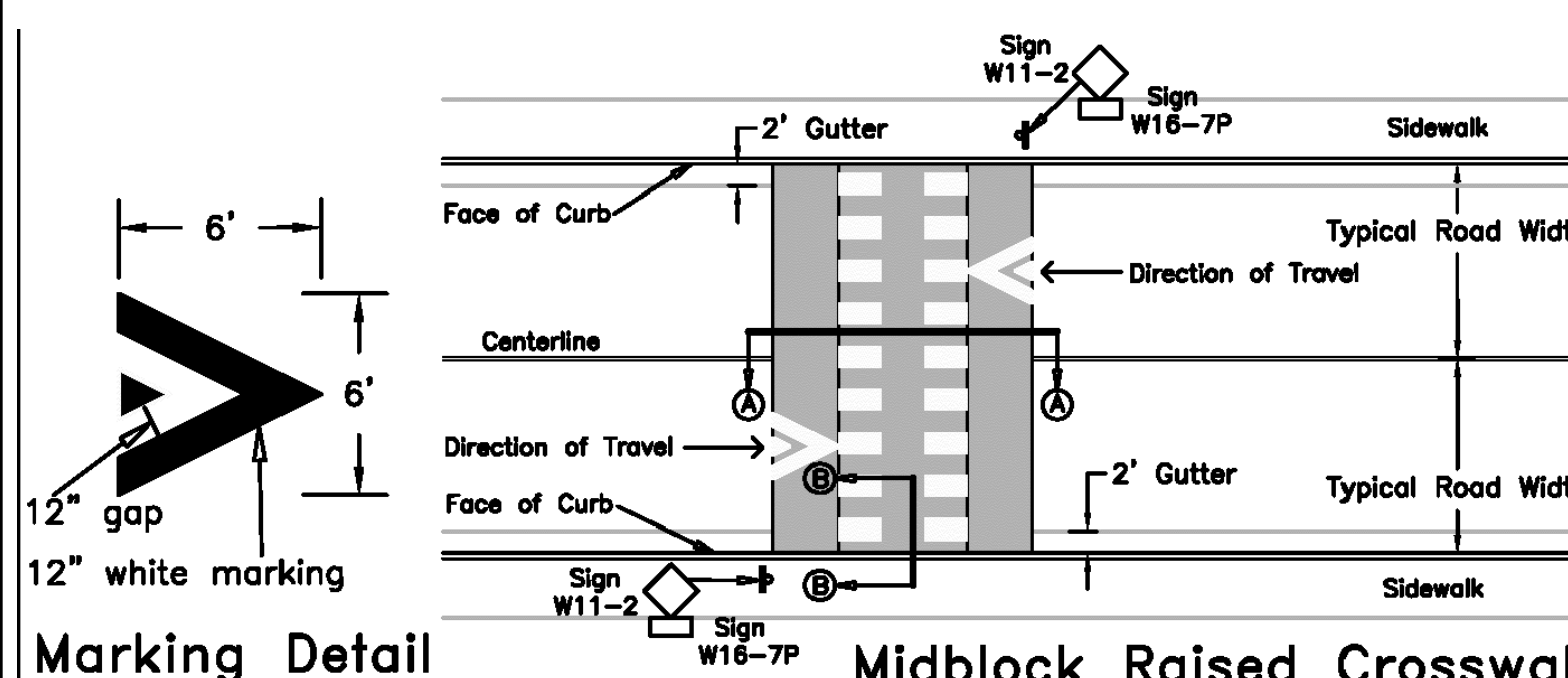

10 RAISED HMA CROSSWALK  
N.T.S.

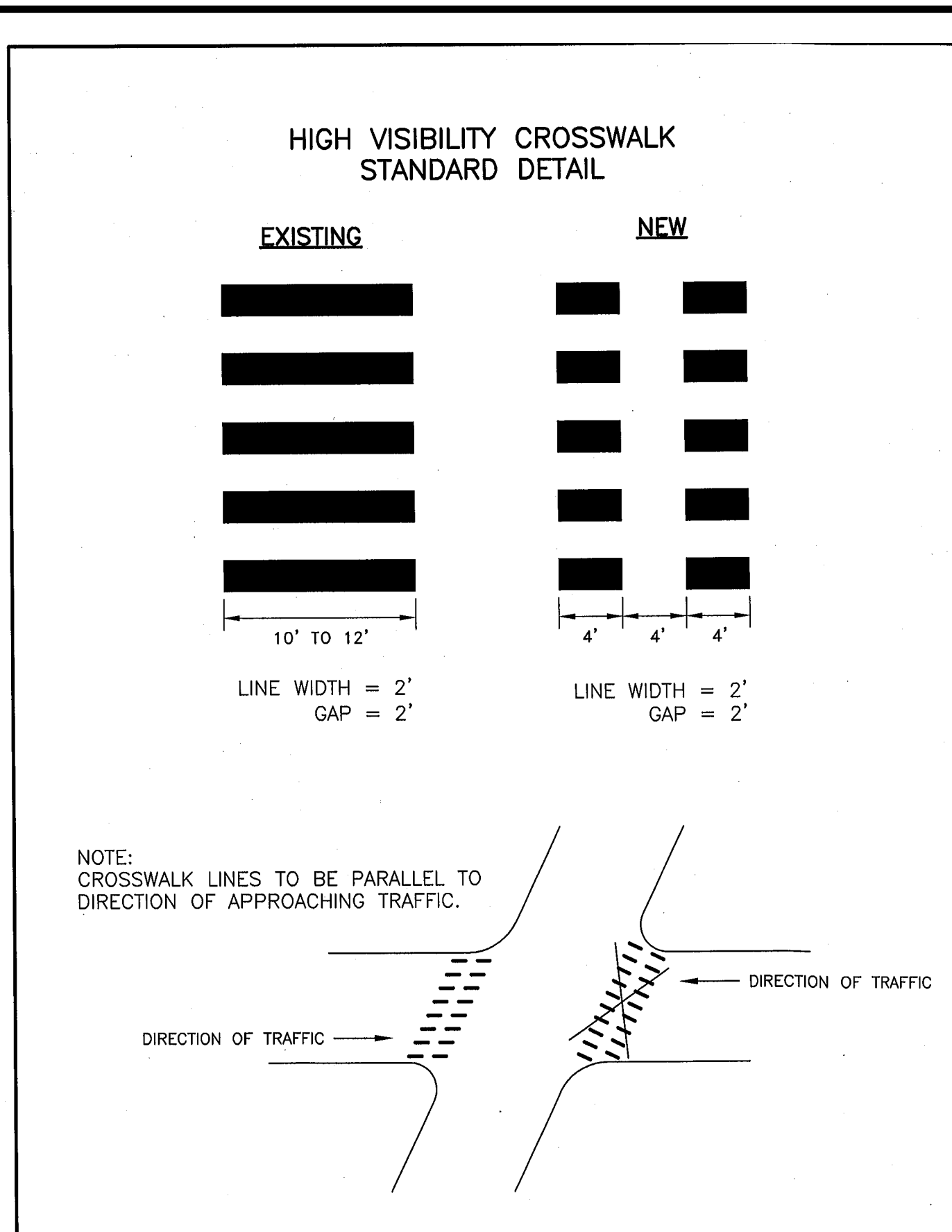

CITY OF BERKELEY DEPARTMENT OF PUBLIC WORKS		STANDARD DETAIL HIGH VISIBILITY CROSSWALK	
SUBMITTED: H. Montzari	DATE: 7/3/13	DESIGN: ZT	DATE: 07-13
SUPERVISING TRAFFIC ENGINEER	R.C.E.: J.R. 2226	DRAWN: ZT	SCALE: NONE
APPROVED:	EXP: Sep 2013	CHECK: HM	BOOK:
MANAGER OF PW-TRANSPORTATION	EXP:	FILE: 20B-151	

11 HIGH VISIBILITY CROSSWALK  
N.T.S.

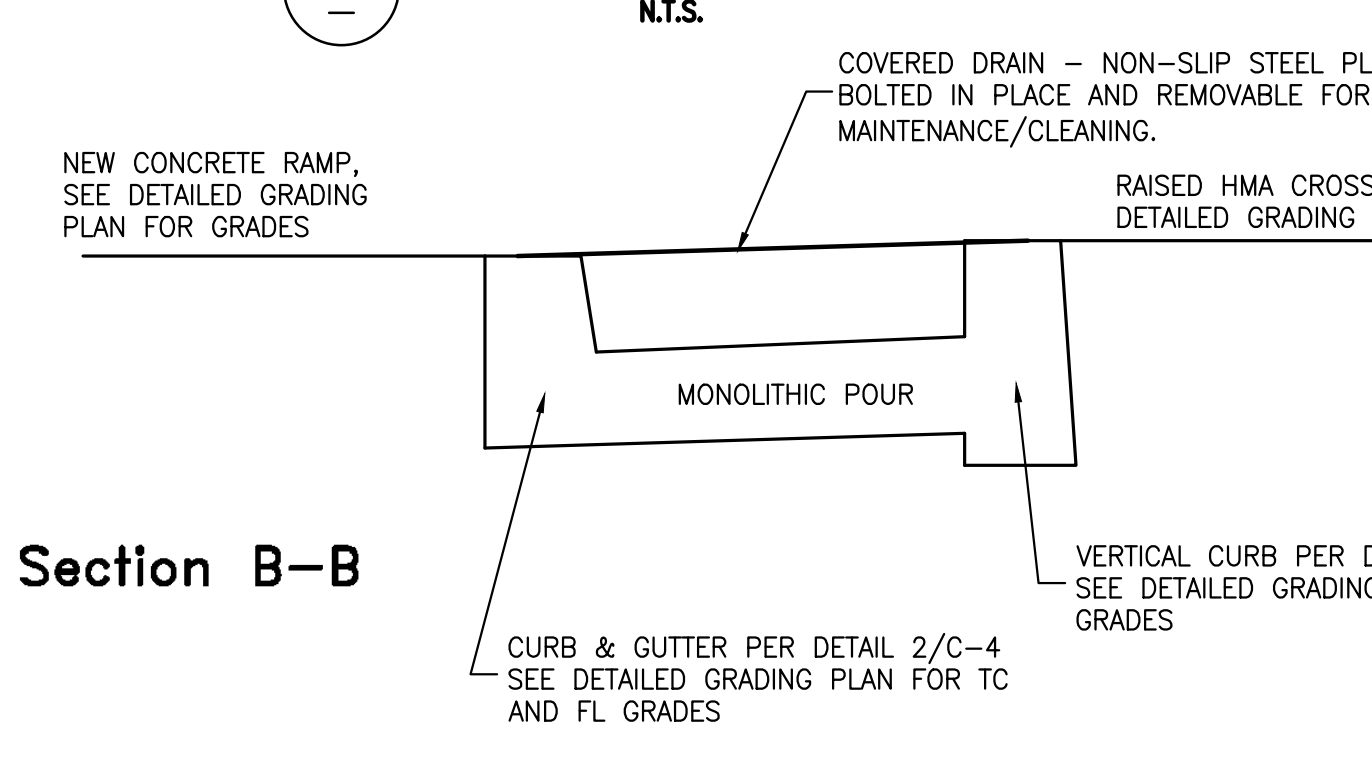

- General Notes:
- Raised crosswalks shall not be placed over manholes, water gates, etc.
  - Edge of raised crosswalk shall be at least 4' away from edge of driveway.
  - Whenever possible raised crosswalk should be placed at extension of property lines instead of mid lot.
  - Whenever possible raised crosswalk should be placed so that adjacent street lights illuminate the approach to the crosswalk and the profile of pedestrians in the crosswalk.
  - All markings and signs shall be reflective.

DESIGN: HM	DATE: 4/5/2022	PLAN: 8209	CITY OF BERKELEY DEPARTMENT OF PUBLIC WORKS STANDARD DETAIL
DRAWN: ZT	SCALE: N.T.S.	FILE: 20B-172	
CHECK: HM			

13 CONCRETE DRIVEWAY  
N.T.S.

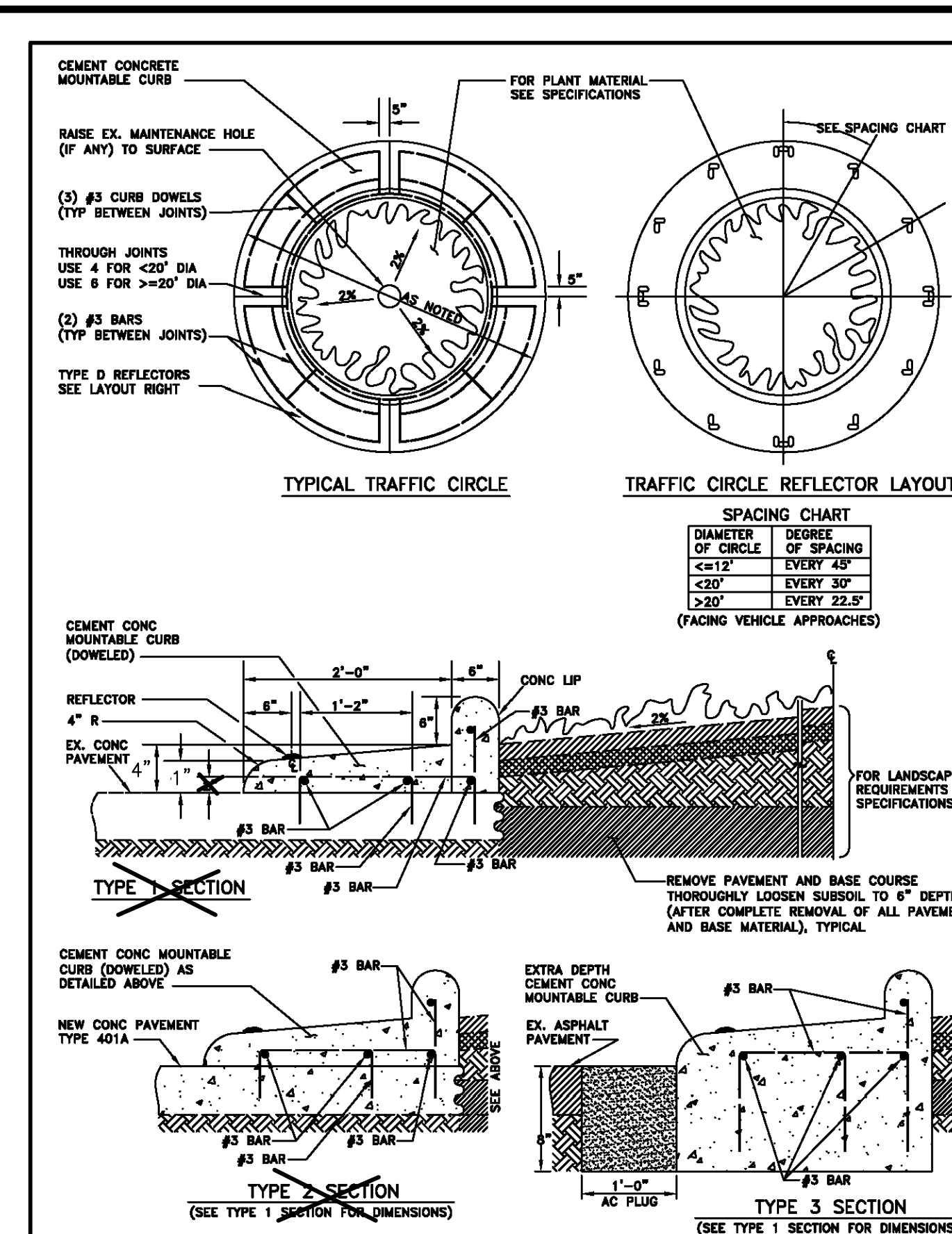

CITY OF BERKELEY DEPARTMENT OF PUBLIC WORKS		STANDARD DETAIL TRAFFIC CIRCLE	
SUBMITTED:	DATE:	DESIGN: HM	DATE: 8-2-2019
SUPERVISING CIVIL ENGINEER	R.C.E.:	DRAWN: ZT	SCALE: N.T.S.
APPROVED:	EXP:	CHECK: X	BOOK: X
MANAGER OF ENGINEERING	EXP:	FILE: X	

12 TRAFFIC CIRCLE  
N.T.S.

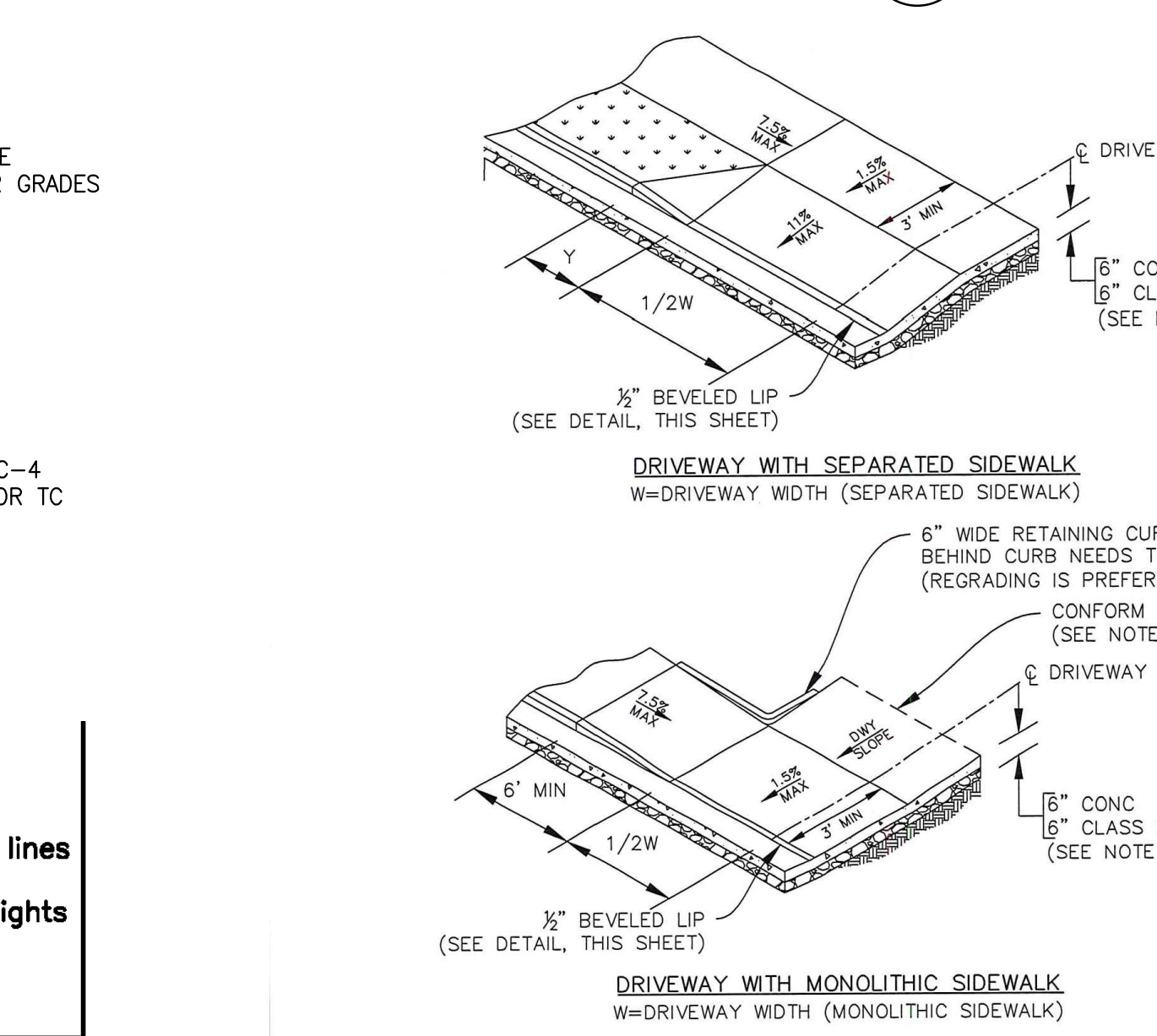

CITY OF BERKELEY DEPARTMENT OF PUBLIC WORKS		STANDARD DETAIL DRIVEWAY	
SUBMITTED: D. J. ...	DATE: 2/27/17	DESIGN: HEI	DATE: 01/26/17
SUPERVISING CIVIL ENGINEER	R.C.E.: 64582	DRAWN: HEI	SCALE: N.T.S.
APPROVED: P. L. ...	DATE: 2/28/17	CHECK: MS	BOOK:
MANAGER OF ENGINEERING	R.C.E.: 66014	FILE: 20B-163	SHEET: 1 OF 1

13 CONCRETE DRIVEWAY  
N.T.S.

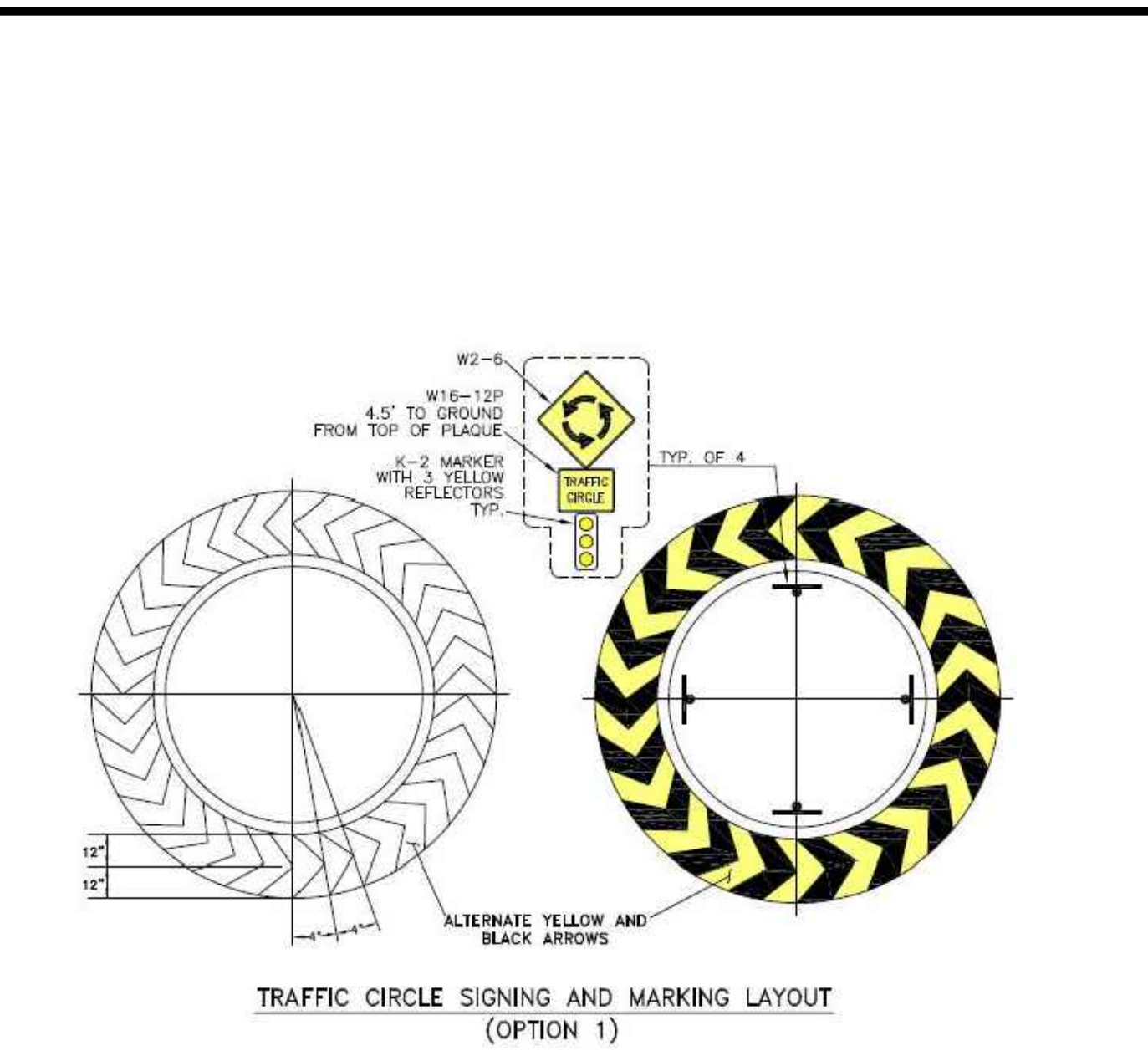

CITY OF BERKELEY DEPARTMENT OF PUBLIC WORKS		STANDARD DETAIL TRAFFIC CIRCLE	
SUBMITTED:	DATE:	DESIGN: HM	DATE: 8-2-2019
SUPERVISING CIVIL ENGINEER	R.C.E.:	DRAWN: ZT	SCALE: N.T.S.
APPROVED:	EXP:	CHECK: X	BOOK: X
MANAGER OF ENGINEERING	EXP:	FILE: X	

12 TRAFFIC CIRCLE  
N.T.S.

REGISTERED PROFESSIONAL ENGINEER  
NOEL B. CRISOLDI  
C 86,603  
CIVIL  
STATE OF CALIFORNIA

03/22/24

ENGINEERING & SURVEYING, INC.  
930 Estudillo Street  
Marina, California 94053-1620  
(925) 229-4218 Fax (925) 229-4638  
www.lsc-inc.com

PROJECT MANAGER: \_\_\_\_\_ DATE: \_\_\_\_\_  
DEPICTION OF MONUMENTS: \_\_\_\_\_ DATE: \_\_\_\_\_  
SURVEY PARTY CHIEF: \_\_\_\_\_ DATE: \_\_\_\_\_  
WATERSHED REVIEW: \_\_\_\_\_ DATE: \_\_\_\_\_

SUBMITTED: \_\_\_\_\_ DATE: \_\_\_\_\_  
SUPERVISING CIVIL ENGINEER: \_\_\_\_\_ R.C.E.: \_\_\_\_\_  
APPROVED: \_\_\_\_\_ DATE: \_\_\_\_\_  
CITY ENGINEER: \_\_\_\_\_ R.C.E.: \_\_\_\_\_

DESIGN: MMV  
DRAWN: NBC  
CHECK: CMP  
AS BUILT: \_\_\_\_\_

HORIZ. \_\_\_\_\_  
VERT. \_\_\_\_\_  
BOOK \_\_\_\_\_  
DATE: 03/22/24

CITY OF BERKELEY  
DEPARTMENT OF PUBLIC WORKS

PEDESTRIAN IMPROVEMENTS AT INTERSECTION  
OF WOOLSEY STREET AT ETON AVE  
CIVIL CONSTRUCTION DETAILS

PLAN: 8276  
FILE: 503-635  
C-5  
SHEET: 9 OF 10



**GENERAL NOTES:**

1. STRIPING SHALL CONFORM TO 2014 CAMUTCD (REV 6, DATED 2021). ALL OTHER WORK SHALL CONFORM TO THE 2022 CALTRANS STANDARD PLANS AND LATEST REVISED PLANS, 2022 CALTRANS STANDARD SPECIFICATIONS AND SPECIAL PROVISIONS, CITY OF BERKELEY STANDARD DETAILS, AND PROJECT SPECIAL PROVISIONS.
2. PAINT RED CURB AT CURB RAMPS PER CURRENT CAMUTCD (20' MIN. AT RETURNS) AND AS DIRECTED BY ENGINEER.
3. SIGNS W11-2 AND W16-7P SHALL BE MOUNTED ON SAME POST.
4. ALL EXISTING ROADWAY SIGNS ARE TO REMAIN AND SHALL BE PROTECTED, UNLESS OTHERWISE NOTED ON PLANS.
5. NEW SIGNS SHALL BE INSTALLED ON NEW POST AND FOUNDATION, UNLESS OTHERWISE NOTED ON PLANS.

**SIGNAGE LEGEND**

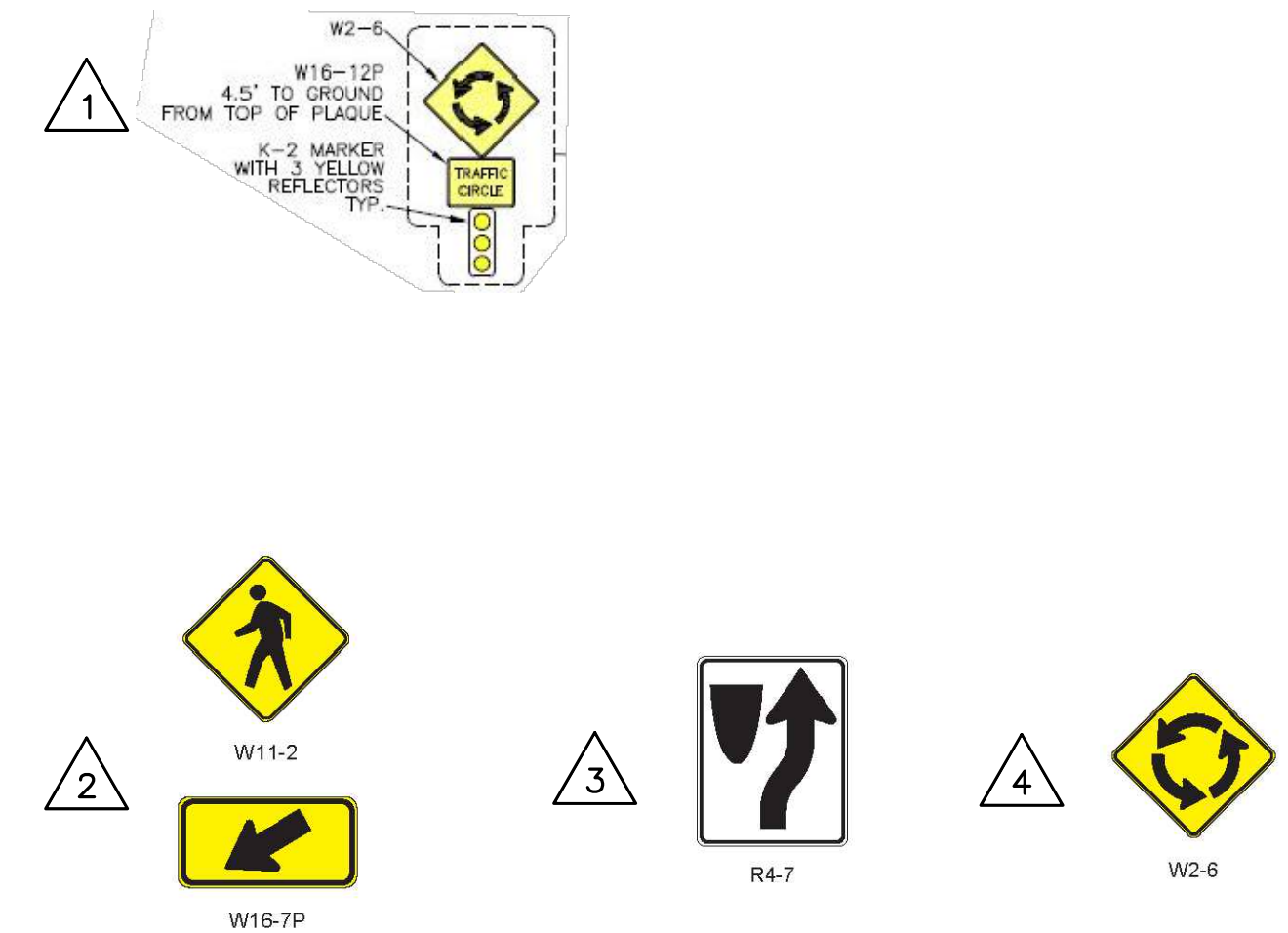

**SIGNAGE & STRIPING NOTES**

- 1 DEMO EX SIGN, POST, & FOUNDATION (SALVAGE CONC PLANTERS)
- 2 RELOCATE EX SIGN AND POST TO NEW LOCATION AND INSTALL IN NEW FOUNDATION
- 3 SALVAGE EX STREET NAME SIGNS "ETON" & "WOOLSEY" FOR REUSE. DEMO POST AND FOUNDATION.
- 4 REINSTALL STREET NAME SIGNS "ETON" & "WOOLSEY" ON SAME, NEW POST AND FOUNDATION.
- 5 HIGH VISIBILITY CROSS WALK SEE DETAIL 11/C-5.
- 6 4' BLACK & WHITE SPEED BUMP BY TREETOP PRODUCTS, OR APPROVED EQUAL.
- 7 PAINT CURB RED
- 8 WHITE YIELD LINE

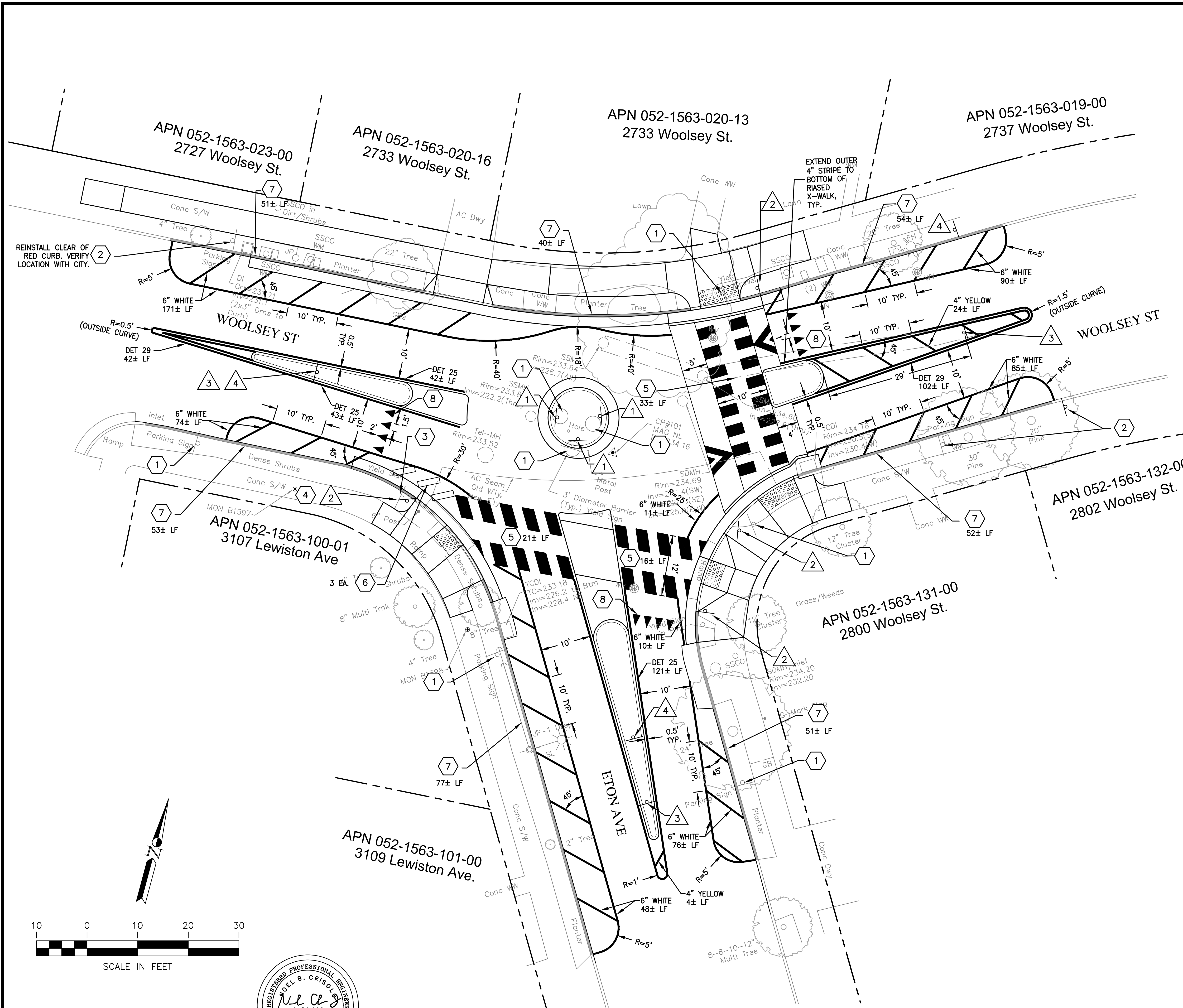

**LCC** ENGINEERING & SURVEYING, INC.  
 930 Estudillo Street  
 Marina, California 94053-1620  
 (925) 228-4218 Fax (925) 228-4938  
 www.lcc-inc.com

PROJECT MANAGER: \_\_\_\_\_ DATE \_\_\_\_\_  
 DEPICTION OF MONUMENTS: \_\_\_\_\_ DATE \_\_\_\_\_  
 SURVEY PARTY CHIEF \_\_\_\_\_  
 WATERSHED REVIEW: \_\_\_\_\_ DATE \_\_\_\_\_

SUBMITTED: \_\_\_\_\_ DATE \_\_\_\_\_  
 SUPERVISING CIVIL ENGINEER \_\_\_\_\_  
 APPROVED: \_\_\_\_\_ DATE \_\_\_\_\_  
 CITY ENGINEER \_\_\_\_\_

DESIGN: **MMV**  
 DRAWN: **NBC**  
 CHECK: **CMP**  
 AS BUILT: \_\_\_\_\_

HORIZ. \_\_\_\_\_  
 VERT. \_\_\_\_\_  
 BOOK \_\_\_\_\_  
 DATE: **03/22/24**

**CITY OF BERKELEY**  
 DEPARTMENT OF PUBLIC WORKS

**PEDESTRIAN IMPROVEMENTS AT INTERSECTION OF WOOLSEY STREET AT ETON AVE**  
**SIGNAGE & STRIPING PLAN**

PLAN **8276**  
 FILE **503-635**  
 SS-1  
 SHEET **10** OF **10**

REVISION	MARK	DATE	DESCRIPTION	APPROVAL